

4

3

2

1

REVISION HISTORY				
ZONE	REV	DESCRIPTION	DATE	APPROVED

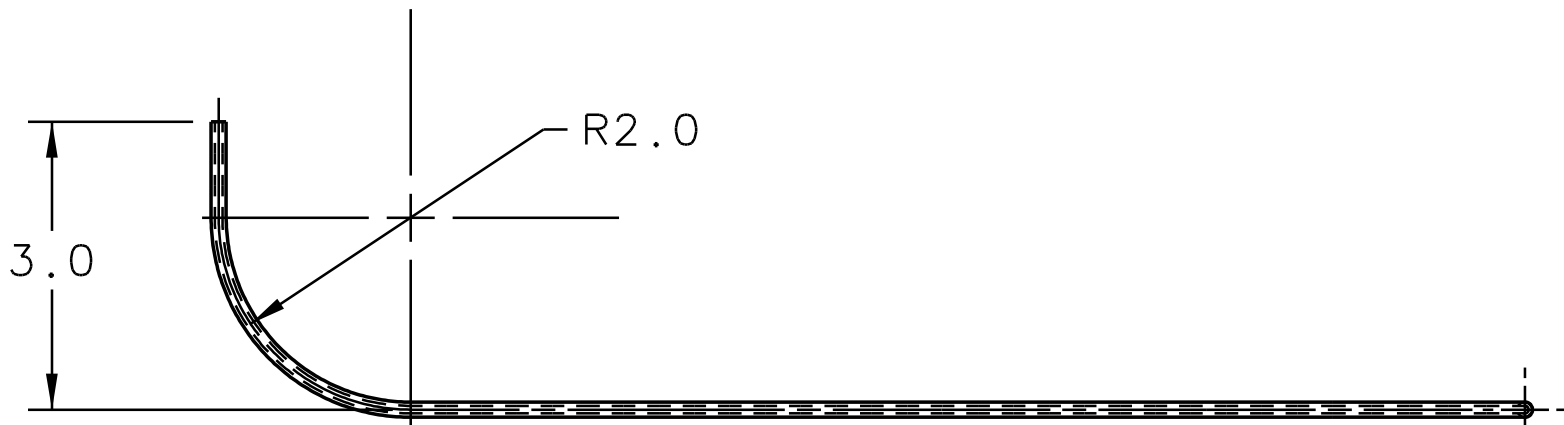

D00000-13-03-2022-02
BEND UP

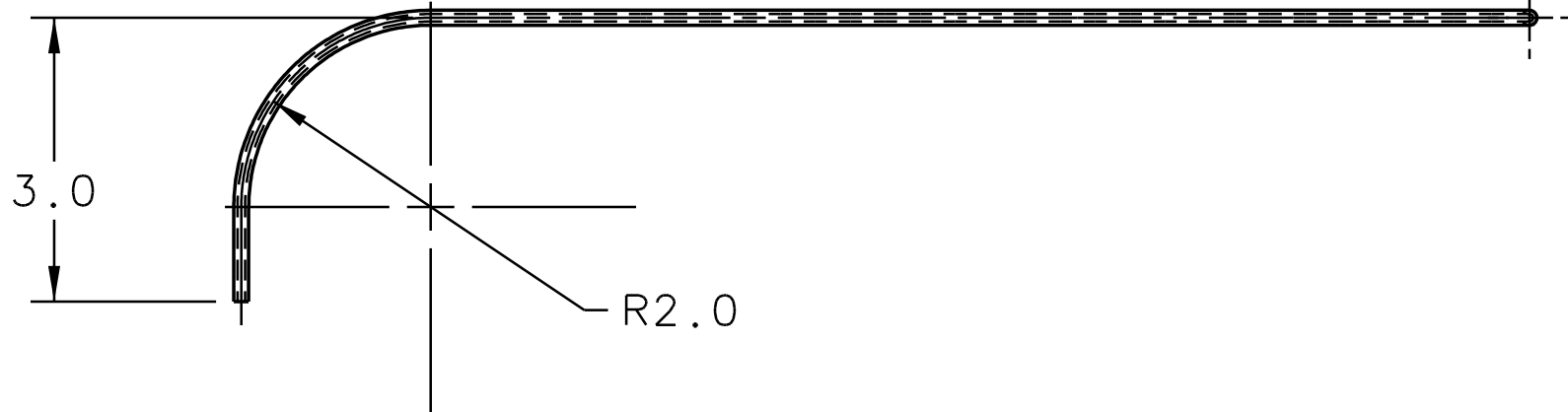
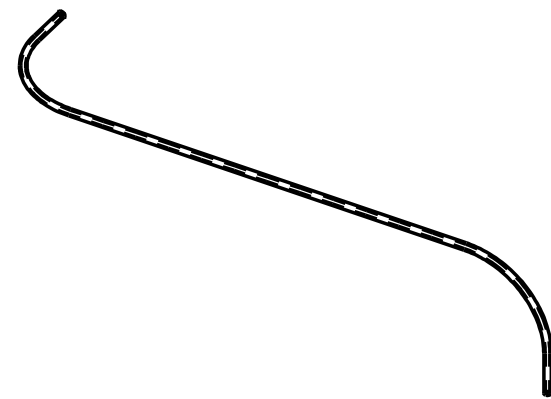

D00000-13-03-2022-01
BEND DOWN

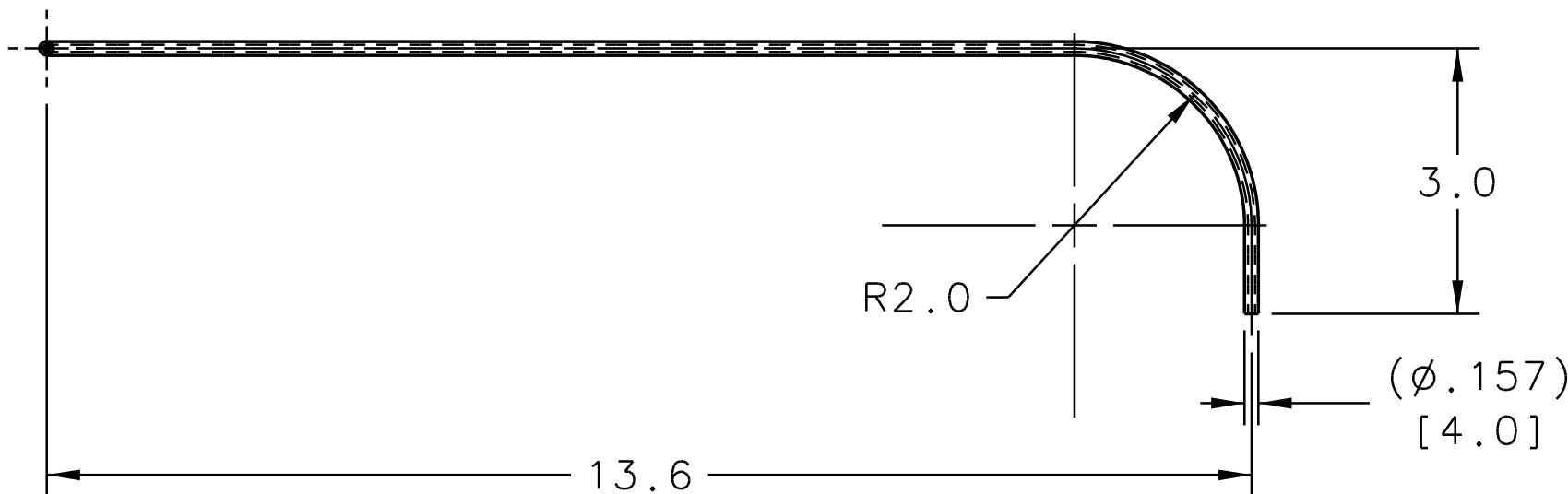
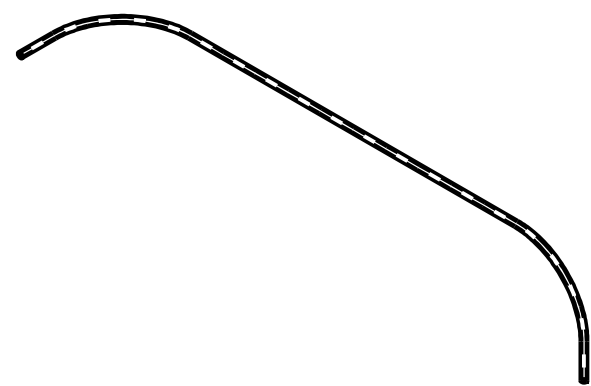

NOTES:

- DIMENSIONS ARE APPROXIMATE. FINAL BENDS TO BE COMPLETED ON NEXT HIGHER ASSEMBLY. LENGTH OF TUBE TO BE 18.0.

DOCUMENT CONTROL STAMP	DIM & TOL PER ASME Y14.5 - UNLESS OTHERWISE SPECIFIED DIMENSIONS ARE IN INCHES TOLERANCES ARE: FRACTIONS DECIMAL ANGLES ± N/A .X ± .1 ± .50° .XX ± .01 .XXX ± .005	TRACKING NO. N/A		United States Department of Energy Jefferson Lab <small>Thomas Jefferson National Accelerator Facility</small> Newport News Virginia
		APPROVALS	DATE	
MATERIAL COPPER TUBE 4MM OD X 2MM ID	THIRD ANGLE PROJECTION	DRAWN R. GETZ	30JAN13	HALL D - GLUEX TEST SETUP FORWARD DRIFT CHAMBER GAUGE TUBING
FINISH MACHINED SURFACES 125 UNLESS OTHERWISE NOTED DEBURR & BREAK ALL SHARP EDGES		CHECKED C. HUTTON		
DO NOT SCALE DRAWING		APPROVED W. CRAHEN		REV. - SCALE 1:2 USED ON ASSY NO. D00000-13-03-1007 SHEET 1 OF 1
		APPROVED T. WHITLATCH		