

DWG. NO. 39200-B-0184

SHT. 1 REV. -

REVISIONS		APPROVED	CONST REL
REV.	DESCRIPTION		

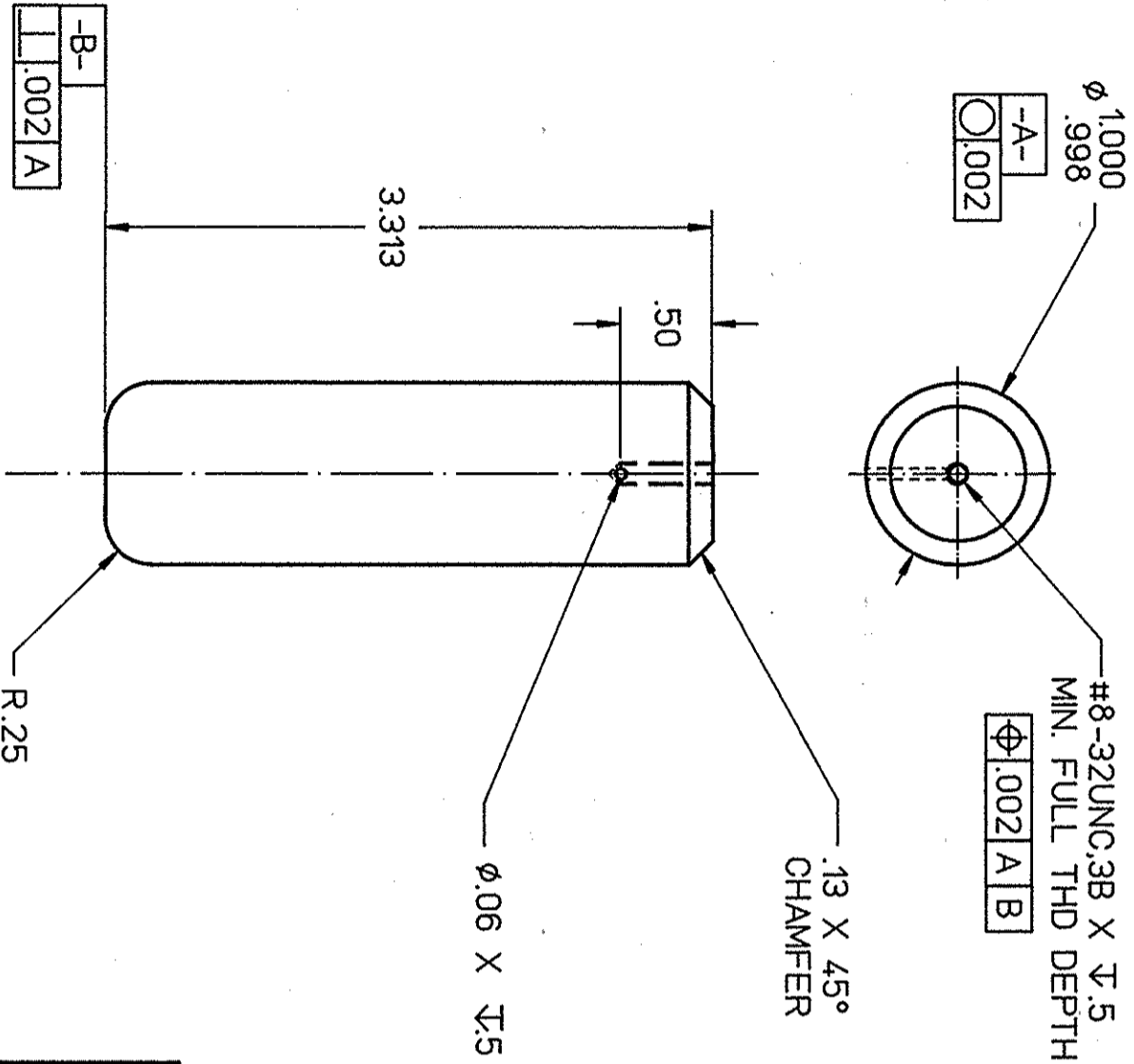

NOTES:

1. ALL MACHINING, CLEANING & HANDLING TO MEET JEFFERSON LAB (CEBAF) SPEC: 22631-S-001 & 22632-S-001.
2. NO SANDING, POLISHING OR USE OF ANY ABRASIVES ALLOWED TO ACHIEVE SPECIFIED FINISHES. REQUIRED FINISH TO BE ACHIEVED BY MACHINING ONLY.
3. MATERIAL CERTIFICATION REQUIRED FROM FABRICATOR
4. MANUFACTURING CERTIFICATION REQUIRED FROM FABRICATOR

DIM & TOL PER ANSI Y14.5 UNLESS OTHERWISE SPECIFIED DIMENSIONS ARE IN INCHES TOLERANCES ARE: FRACTIONS DECIMAL ANGLES # N/A .XXX ± .005 ± .5°		CADD I.D. NO. /wbs/3/39200/0b0184		Thomas Jefferson National Accelerator Facility NEWPORT NEWS, VIRGINIA UNITED STATES DEPARTMENT OF ENERGY	
MATERIAL TELLURIUM COPPER		APPROVALS DRAWN Michael Lloyd 04/16/97		BEAM TRANSPORT HALL 'B' BEAM POSITION MONITOR PROBE TIP	
FINISH 32 UNLESS OTHERWISE NOTED DEBURR & BREAK ALL SHARP EDGES		CHECKED APPROVED CONST RELEASE		SIZE DWG. NO. B 39200-B-0184	
DO NOT SCALE DRAWING		DATE 5-6-97 5-7-97 5/7/97		SCALE FULL USED ON ASSY NO. 39200-E-0175 SHEET 1 OF 1	

100%