

DWG. NO. 39200-B-0196 SHT. 1 REV. -

| REVISIONS | | |
|-----------|------|-------------|
| ZONE | REV. | DESCRIPTION |
| | | DATE |
| | | APPROVED |

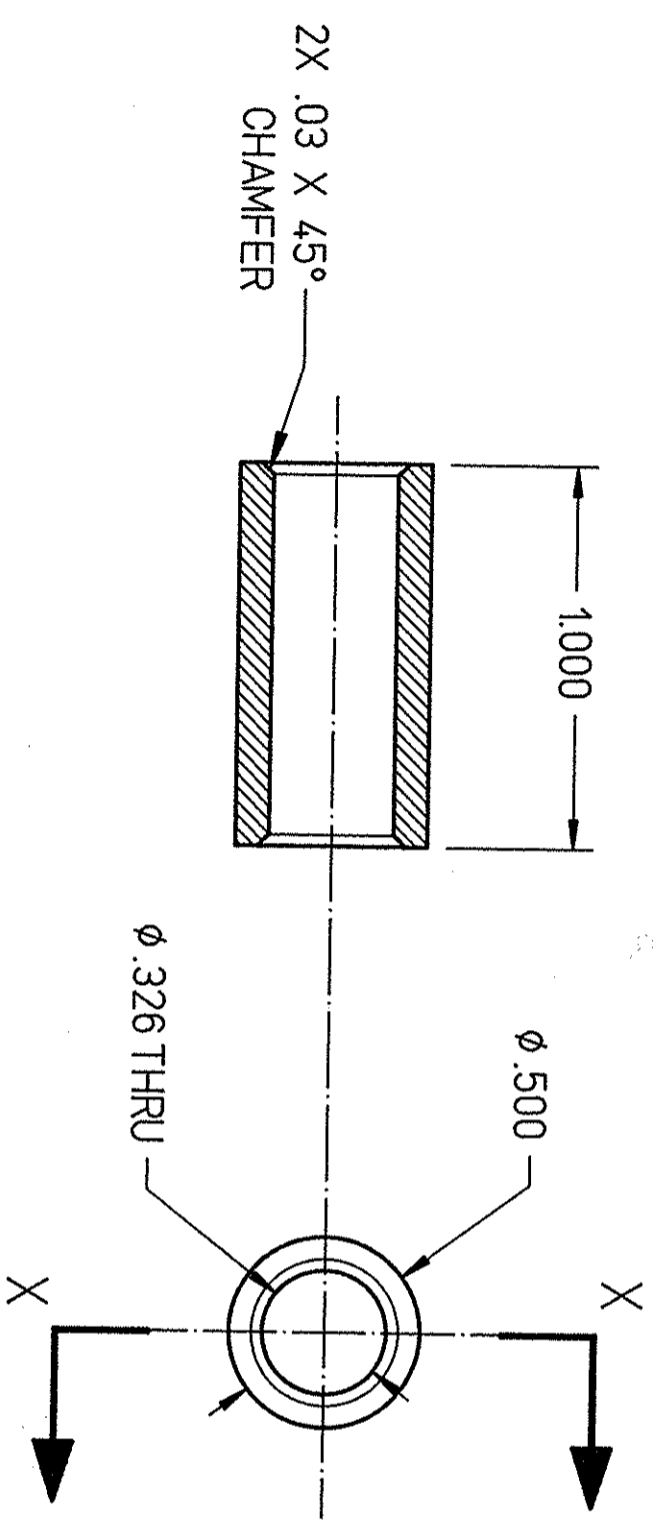

SECTION X-X

| | | | | | |
|--|--|--------------------------------------|------------------|--|--|
| DIM & TOL PER ANSI Y14.5 UNLESS OTHERWISE SPECIFIED DIMENSIONS ARE IN INCHES TOLERANCES ARE: FRACTIONS DECIMAL ANGLES ± N/A .XX ± .01 ± .25° .XXX ± .005 | | CADD I.D. NO. /wbs/3/39200/0b0196 | | Thomas Jefferson National Accelerator Facility NEWPORT NEWS, VIRGINIA UNITED STATES DEPARTMENT OF ENERGY | |
| MATERIAL 304 STAINLESS STEEL | | DRAWN Jacki R. Smith | DATE 02/03/97 | BEAM TRANSPORT INJECTOR PRE-BUNCHER FEEDTHRU STOP | |
| FINISH 125 UNLESS OTHERWISE NOTED DEBURR & BREAK ALL SHARP EDGES | | CHECKED <i>[Signature]</i> | 2-4-97 | SIZE DWG. NO. B 39200-B-0196 | REV. - |
| DO NOT SCALE DRAWING | | APPROVED <i>[Signature]</i> | 2/4/97 | SCALE 2:1 | USED ON ASSY NO. 39200-E-0186 SHEET 1 OF 1 |

