

DWG. NO.	39200-C-0201	SHT.	1	REV.	1
REVISIONS					
ZONE	REV.	DESCRIPTION	DATE	APPROVED	

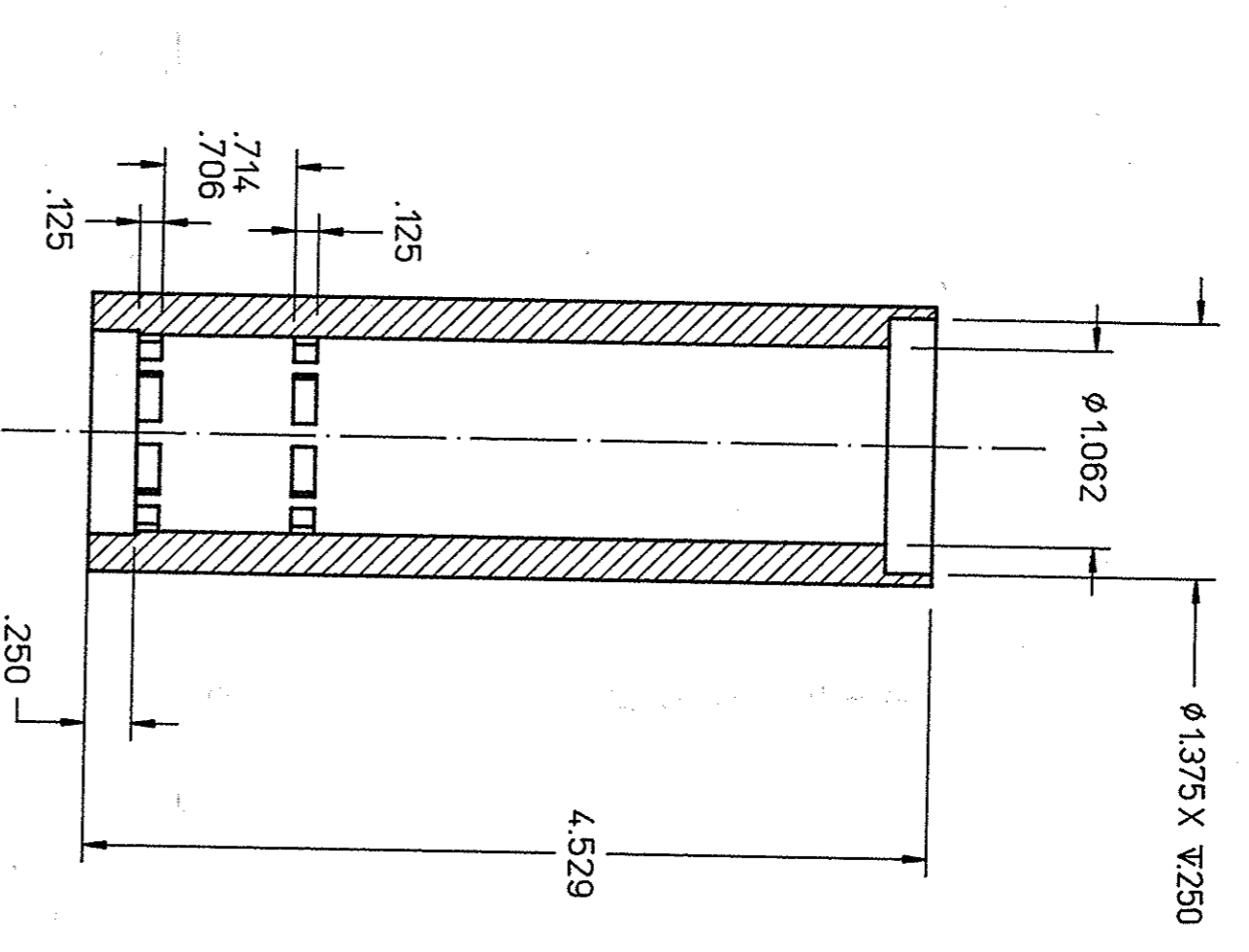

SECTION Z-Z

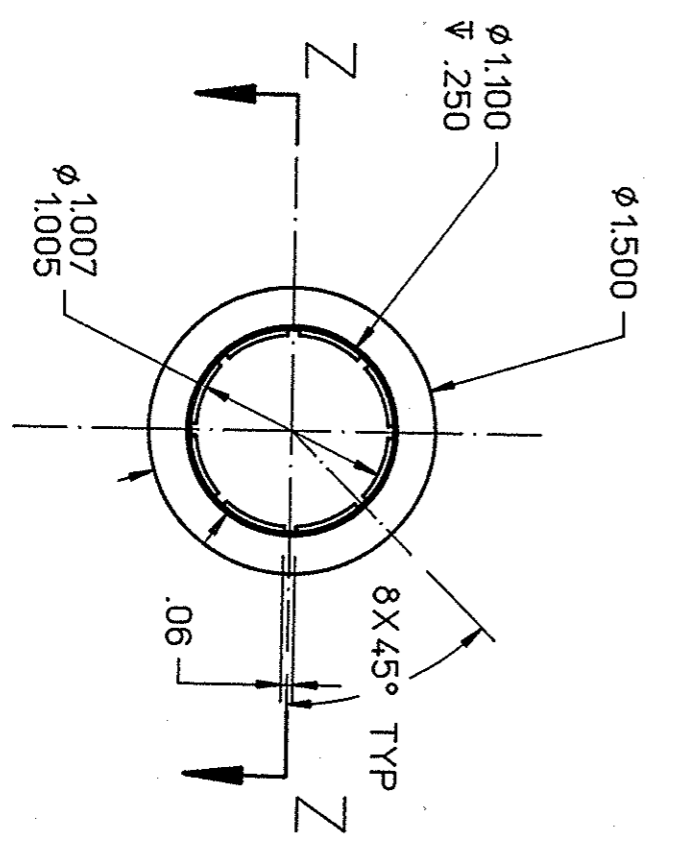

- NOTES:
1. ALL MACHINING, CLEANING AND HANDLING TO MEET CEBAF SPEC 22631-S-001 & 22632-S-001.
 2. NO SANDING OR POLISHING ALLOWED. REQUIRED FINISHED TO BE ACHIEVED BY MACHINING ONLY.
 3. MATERIAL CERTIFICATE REQUIRED.
 4. MANUFACTURING CERTIFICATE REQUIRED.

QTY	ITEM	PART OR IDENTIFYING NO.	NOMENCLATURE OR DESCRIPTION	MATERIAL SPECIFICATION	NOTES
			PARTS LIST		
			CADD I.D. NO.		
			'/wbs/3/39200/060201'		
			DRAWN	DATE	
			MICHAEL LLOYD	04/30/97	
			CHECKED	DATE	
				5-6-97	
			APPROVED	DATE	
				5-7-97	
			APPROVED	DATE	
				5/1/97	
FINISH 63 UNLESS OTHERWISE NOTED DEBURR & BREAK ALL SHARP EDGES DO NOT SCALE DRAWING					
DIM & TOL PER ANSI Y14.5 UNLESS OTHERWISE SPECIFIED DIMENSIONS ARE IN INCHES TOLERANCES ARE: FRACTIONS DECIMAL ANGLES \pm N/A .XXX \pm .01 \pm .5° \pm N/A .XXX \pm .002			Thomas Jefferson National Accelerator Facility UNITED STATES DEPARTMENT OF ENERGY MICHAEL LLOYD HALL "B" BEAM POSITION MONITOR BEAM TRANSPORT TUNING PORT TUBE		
MATERIAL		304 STAINLESS STEEL		FINISH 63 UNLESS OTHERWISE NOTED	
SCALE		FULL		USED ON ASSY NO. 39200-E-0175	
SIZE		DWG. NO. 39200-C-0201		SHEET 1 OF 1	
REV.		-		-	

