

REVISION HISTORY			
REV	DESCRIPTION	DATE	APPROVED
A	.25-20UNC WAS .28 THRU. ADD 63 FIN ON TP & BTM. ADD STOCK SPEC TO .75 THK. 2PLC TOL WAS .01 . KHS FEB 04	24 FEB 04	WELH
		24 FEB 04	ETD

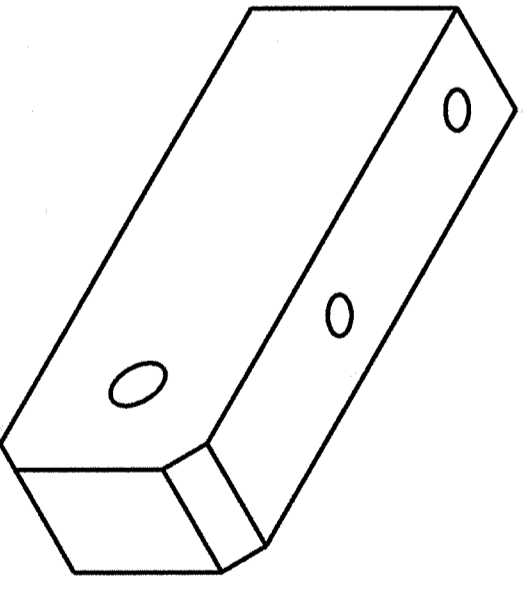
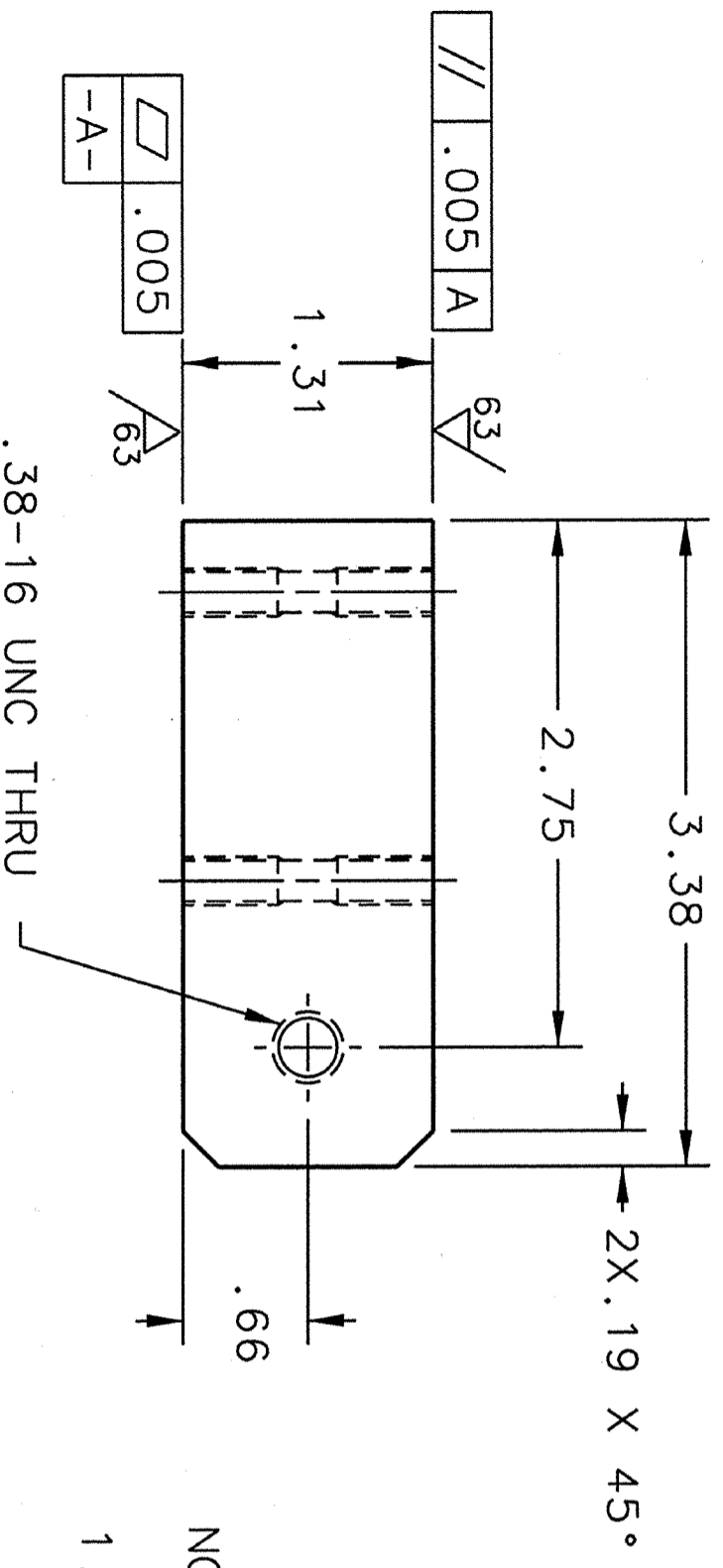
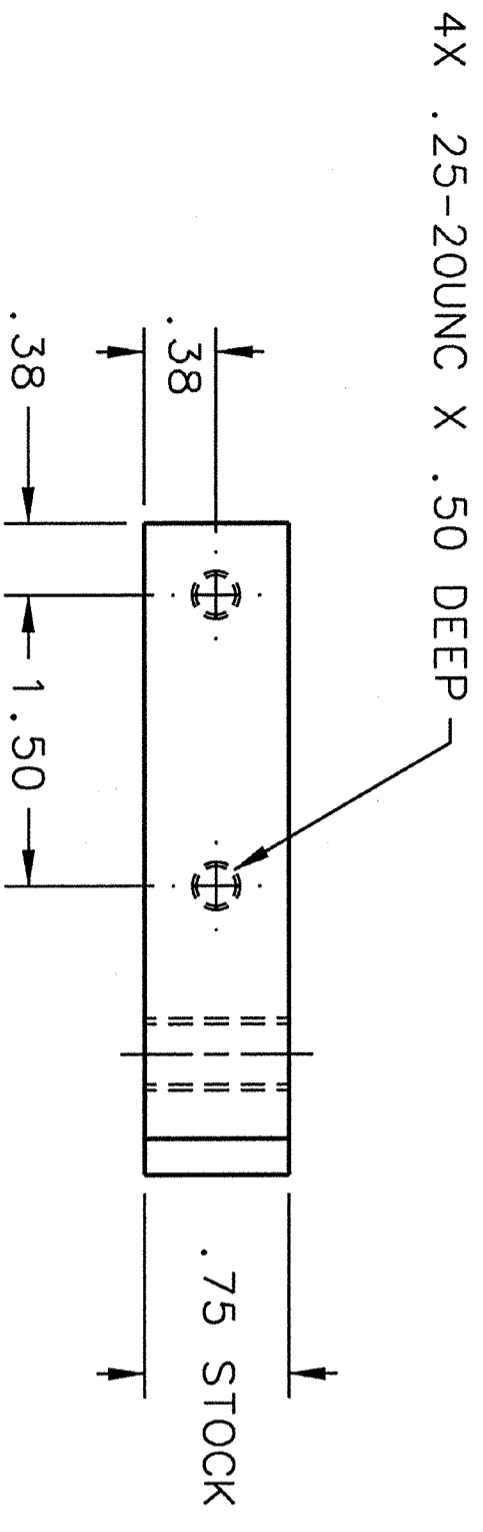

NOTES:

- CLEAN AND HANDLE FINISHED PART PER TUNAF SPECIFICATION 11141-S-0034.

<b>DOCUMENT CONTROL STAMP</b> 		<small>DIM &amp; TOL PER ASME Y14.5 UNLESS OTHERWISE SPECIFIED DIMENSIONS ARE IN INCHES TOLERANCES ARE IN INCHES FRACTIONS DECIMAL ANGLES</small> <table border="1"> <tr> <td>1N/A</td> <td>X</td> <td>1.1</td> <td>1.50°</td> </tr> <tr> <td></td> <td>.XX</td> <td>1.05</td> <td></td> </tr> <tr> <td></td> <td>.XXX</td> <td>1.005</td> <td></td> </tr> </table>		1N/A	X	1.1	1.50°		.XX	1.05			.XXX	1.005	
1N/A	X	1.1	1.50°												
	.XX	1.05													
	.XXX	1.005													
<b>MATERIAL</b> 316L STAINLESS STEEL		<b>TRACKING NO.</b> N/A													
<b>FINISH</b> 125 UNLESS MACHINED SURFACES DEBURR & BREAK ALL SHARP EDGES NOTED		<b>APPROVALS</b> <table border="1"> <tr> <th>DATE</th> <th>APPROVED</th> </tr> <tr> <td>05FEB03</td> <td>K.H. SMITH</td> </tr> <tr> <td>4/28/03</td> <td>D. MACHIE</td> </tr> <tr> <td>4/28/03</td> <td>E. DALY</td> </tr> <tr> <td>2/29/03</td> <td>C. REECE</td> </tr> </table>		DATE	APPROVED	05FEB03	K.H. SMITH	4/28/03	D. MACHIE	4/28/03	E. DALY	2/29/03	C. REECE		
DATE	APPROVED														
05FEB03	K.H. SMITH														
4/28/03	D. MACHIE														
4/28/03	E. DALY														
2/29/03	C. REECE														
<b>THIRD ANGLE PROJECTION</b> 		Thomas Jefferson National Accelerator Facility UNITED STATES DEPARTMENT OF ENERGY 													
<b>DO NOT SCALE DRAWING</b>		CRM 100 MV CRYOMODULE TUNER LINKAGE ANCHOR - DETAIL SIZE DWG. NO. CRM1007050-0003 SCALE 1:1 USED ON ASST NO. CRM1007050-0000 SHEET 1 OF 1													