

REVISION HISTORY		
REV	DESCRIPTION	DATE

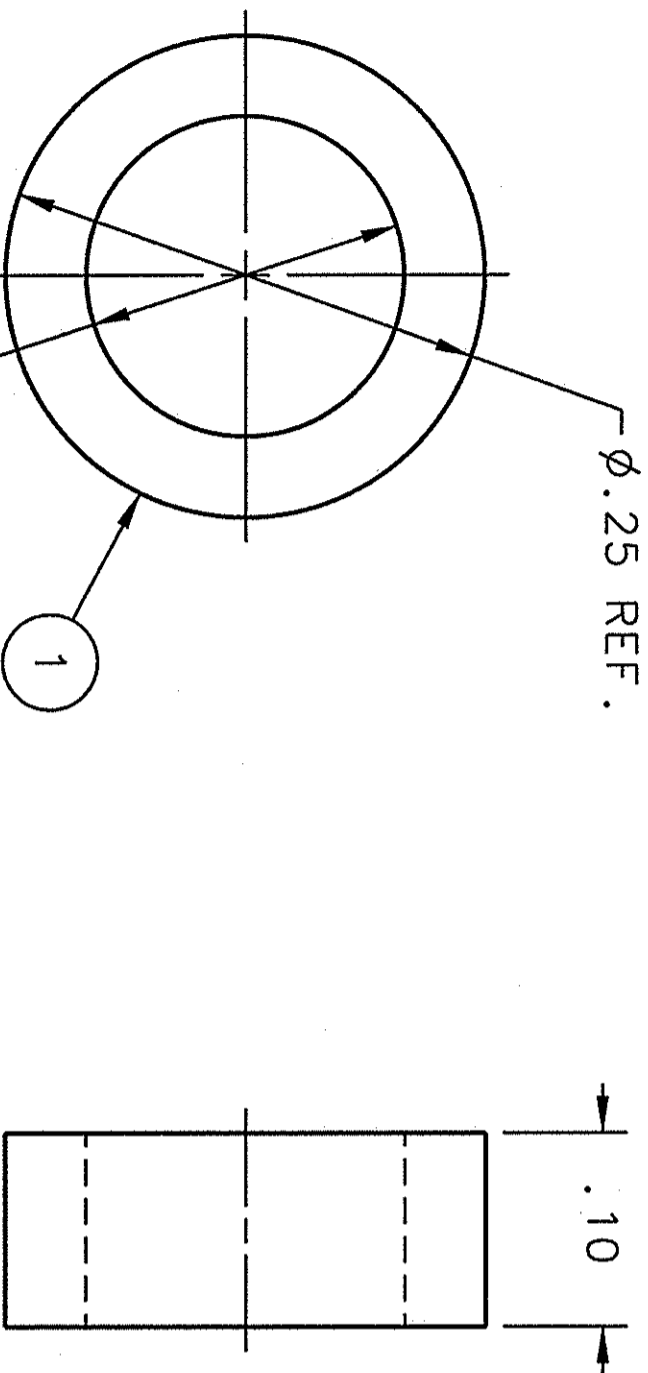

NOTES:

- CLEAN AND HANDLE FINISHED PART PER TUNAF SPECIFICATION 11141-S-0034.

QTY	ITEM NO.	PART OR IDENTIFYING NO.	NOMENCLATURE OR DESCRIPTION	MATERIAL SPECIFICATION	NOTES
1	1	MCMASTER CARR P/N 92207A175	SPACER, .166 ID X .25 OD X .19 LG	316 STAINLESS STEEL	

DOCUMENT CONTROL STAMP

MATERIAL  
 SEE PARTS LIST

FINISH MACHINED SURFACES  
 DEBURR & BREAK ALL SHARP EDGES  
 125  
 UNLESS OTHERWISE NOTED

DIM & TOL. PER ASME Y14.5  
 UNLESS OTHERWISE SPECIFIED  
 TOLERANCES ARE IN INCHES  
 FRACTIONS DECIMAL ANGLES  
 N/A .X ±.1 ±.50°  
 .XX ±.01  
 .XXX ±.005

TRACKING NO. N/A

APPROVALS	DATE
DRAWN K.H. SMITH	05FEB03
CHECKED D. MACCAYE	4/28/03
APPROVED E. Kelly	4/28/03
APPROVED D. Gaea	4/29/03

THOMAS JEFFERSON NATIONAL ACCELERATOR FACILITY  
 NEWPORT NEWS, VIRGINIA  
 UNITED STATES DEPARTMENT OF ENERGY

Jefferson Lab

CRM  
 100 MV CRYOMODULE  
 SWITCH RAIL SPACER - DETAIL

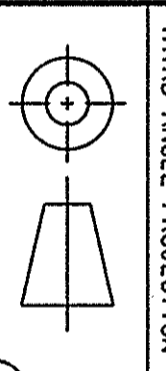

THIRD ANGLE PROJECTION

SIZE DWG. NO. B  
 CRM1007050-0009  
 SCALE 10:1  
 USED OR ASST NO. CRM1007050-0000  
 SHEET 1 OF 1