

REVISION HISTORY				
ZONE	REV	DESCRIPTION	DATE	APPROVED
2C	A	REVISED THICKNESS OF FLANGE FROM .69 TO .77. REVISED FINISH FROM 32 TO 16 MICROINCH. GRB 05JUL01	1-11-01 7-12-01	<i>[Signature]</i>

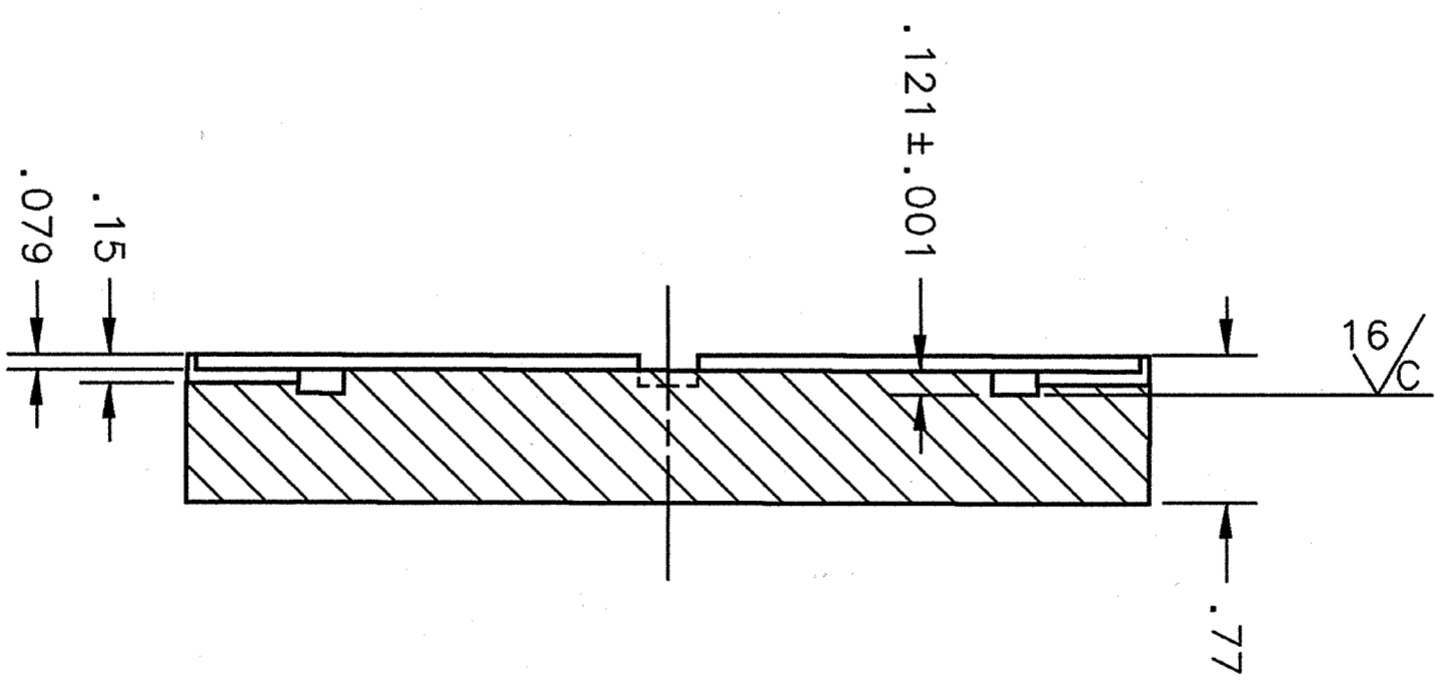
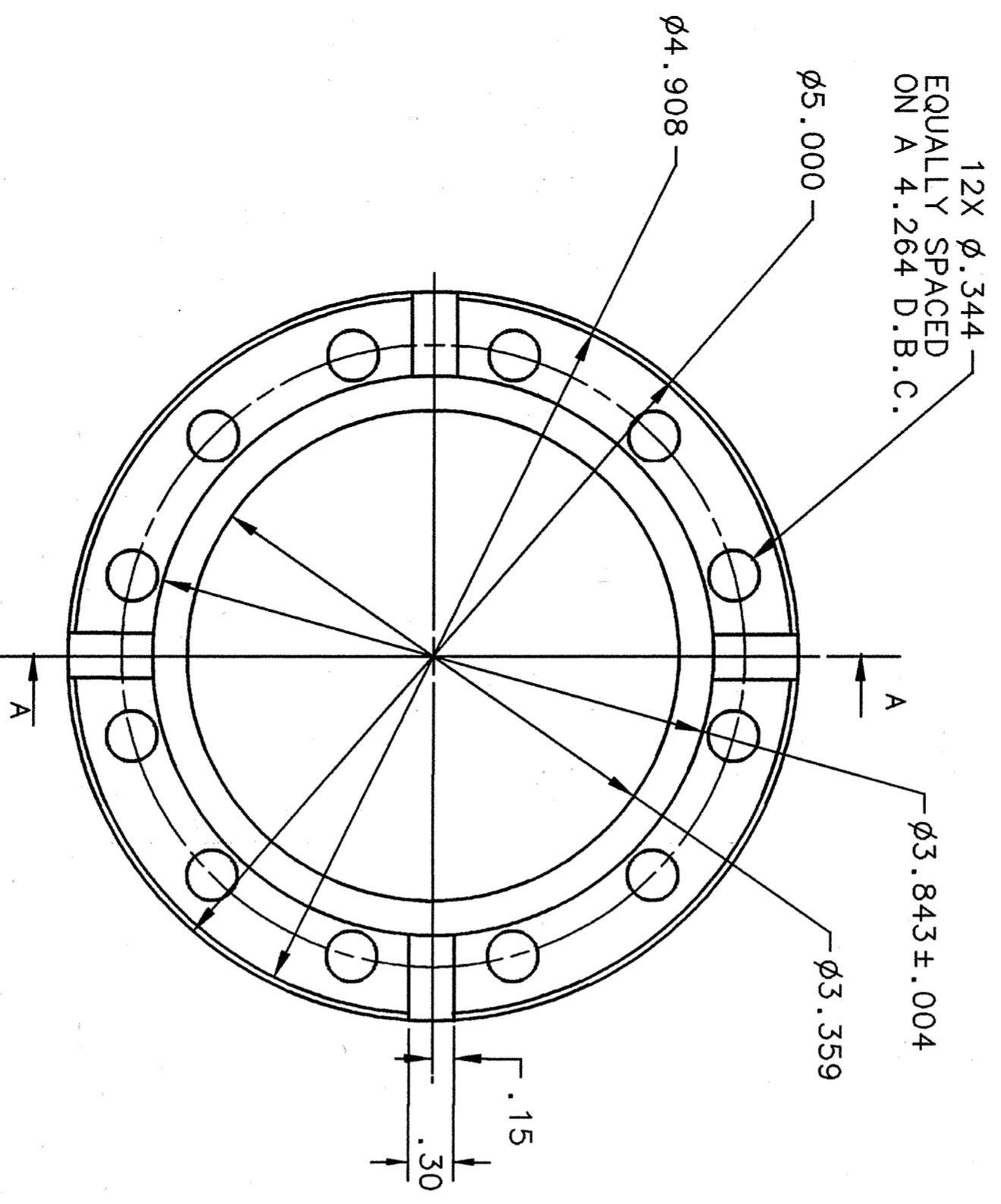

SECTION A - A

DIM & TOL PER ANSI Y14.5 UNLESS OTHERWISE SPECIFIED DIMENSIONS ARE IN INCHES TOLERANCES ARE: DECIMAL FRACTIONS .XX ± .01 .XXX ± .005 ANGLES ± .50°		CADD I.D. NO.: I-DEAS SNS DRAWING NUMBER 101111000-MBC-8200-A099-R00		Thomas Jefferson National Accelerator Facility UNITED STATES DEPARTMENT OF ENERGY	
MATERIAL STAINLESS STEEL TYPE 304		APPROVALS DRAWN R. BISHOP 30AUG00 CHECKED D. MACHIE 10/9/00 APPROVED W. SCHNEIDER 1/12/01 APPROVED P. KNEISEL 1/12/01		BEAM TUBE/FPC BLANK FLANGE DETAIL SIZE DWG. NO. CRM9007010-1054	
FINISH 125 UNLESS OTHERWISE NOTED DEBURR & BREAK ALL SHARP EDGES		DATE		USED ON ASSY NO. CRM9007010-0001/0002 SHEET 1 OF 1	
DO NOT SCALE DRAWING		DATE		REV. A	

*[Handwritten signature]*