

4

3

2

1

| REVISION HISTORY | | | | |
|------------------|-----|-------------|------|----------|
| ZONE | REV | DESCRIPTION | DATE | APPROVED |
| | | | | |

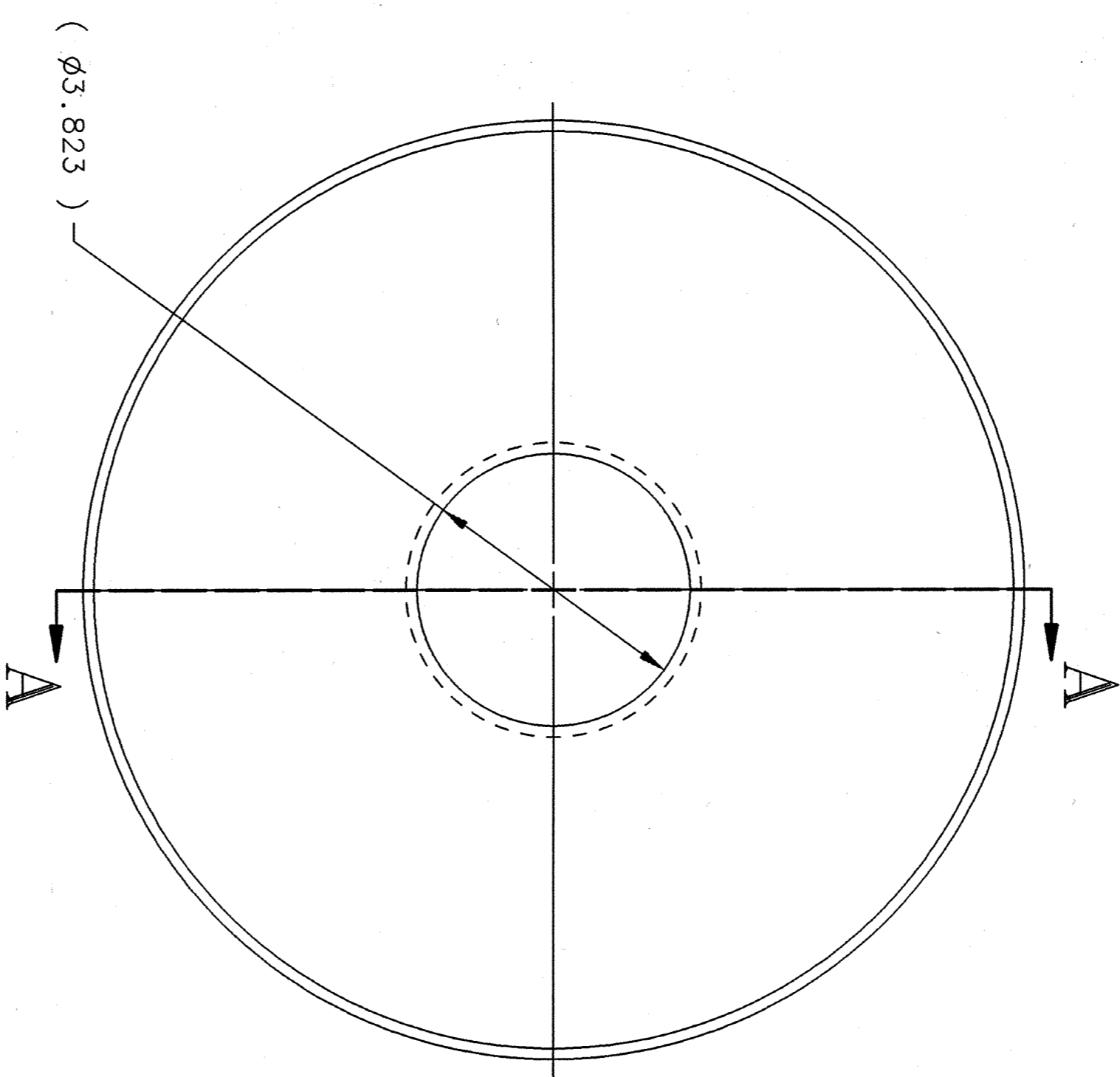
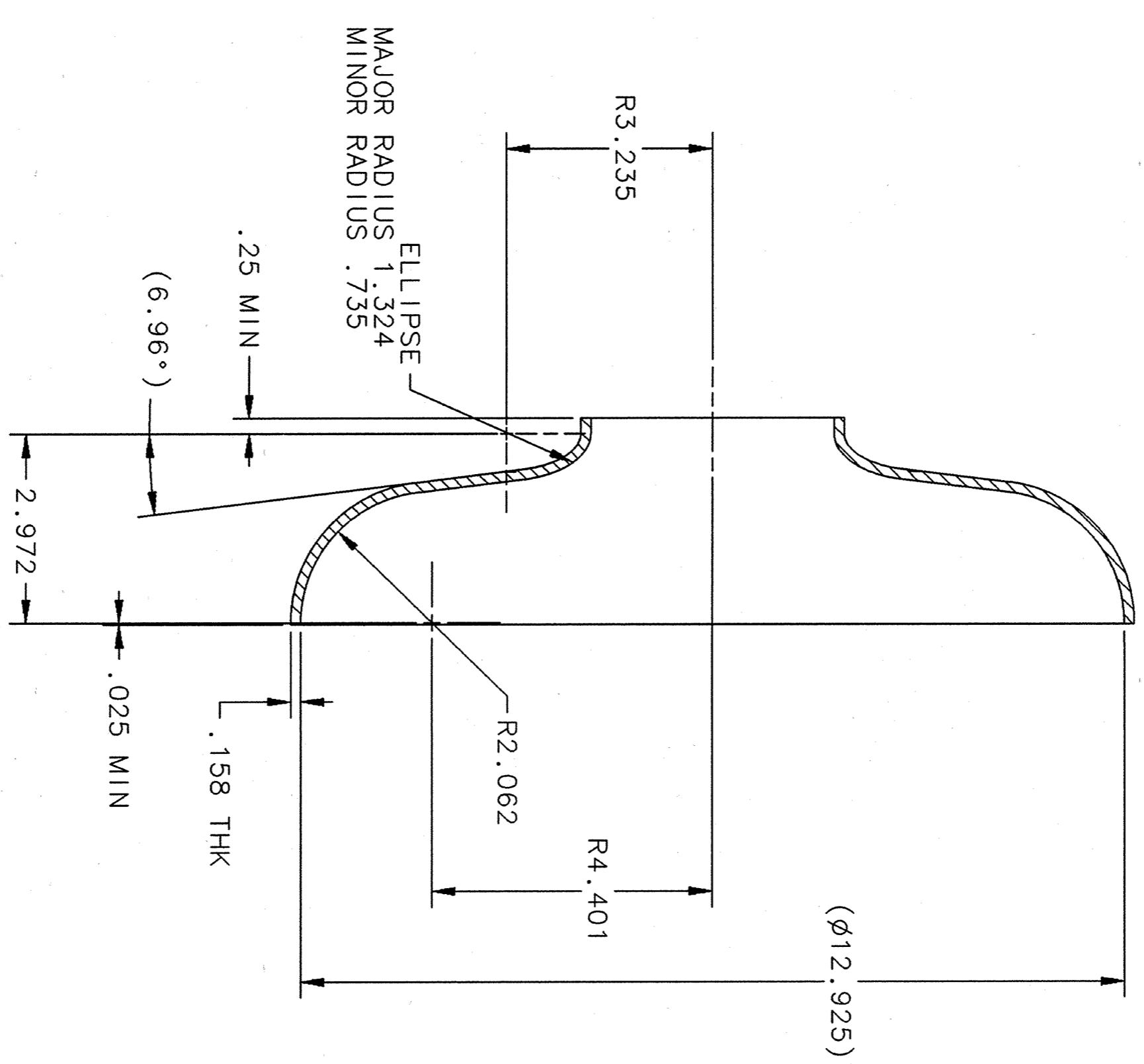

SECTION A-A



| | | | |
|-----------------------------------------------------------------------------------------------------------------------------------------------------------------------|--|-------------------------------------------------------------------------------------------|--|
| DIM. & TOL. PER ANSI Y14.5 UNLESS OTHERWISE SPECIFIED DIMENSIONS ARE IN INCHES TOLERANCES ARE: FRACTIONS DECIMAL ANGLES #N/A .XXX ±.001 .XX ±.01 ±.50° | | CADD I.D. NO.: 1-DEAS SNS DRW NO. 101111000-MBC-8200-A053-R00 | |
| MATERIAL NIOBIUM - GRADE RRR SPEC CRM9000000-1000 | | APPROVALS DRAWN R. GETZ DATE 25JUL00 | |
| FINISH 125 UNLESS OTHERWISE NOTED DEBURR & BREAK ALL SHARP EDGES | | CHECKED DATE 2/1/01 | |
| DO NOT SCALE DRAWING | | APPROVED DATE 2/27/01 | |
| Thomas Jefferson National Accelerator Facility UNITED STATES DEPARTMENT OF ENERGY | | SPALLATION NEUTRON SOURCE 0.81 (HIGH) BETA CRYOMODULE CENTER CELL STAMPING - DETAIL | |
| SCALE 1/2 | | USED ON ASSY NO. CRM9007010-3000/3002 | |
| SHEET 1 OF 1 | | REV. 1 | |

A

B

C

D

4

3

2

1