

REVISION HISTORY				
ZONE	REV	DESCRIPTION	DATE	APPROVED

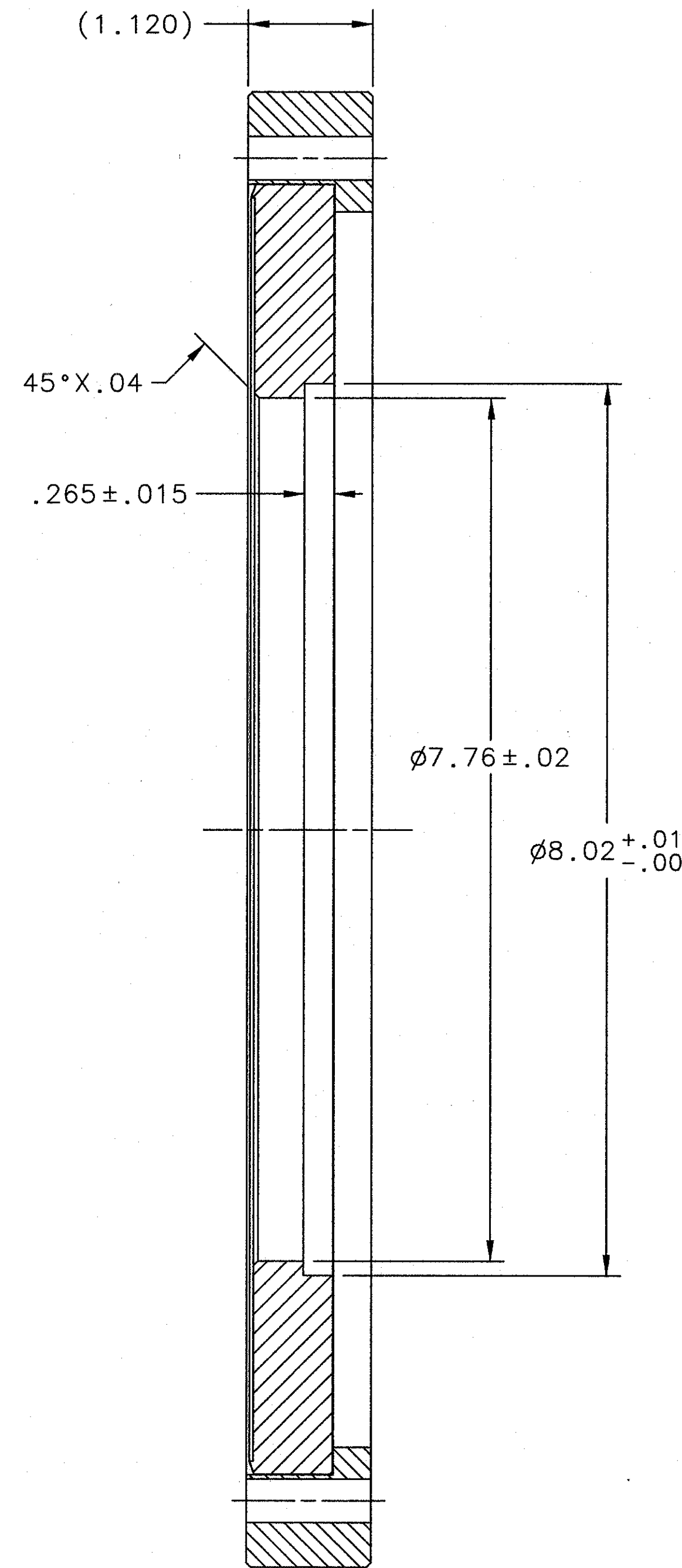
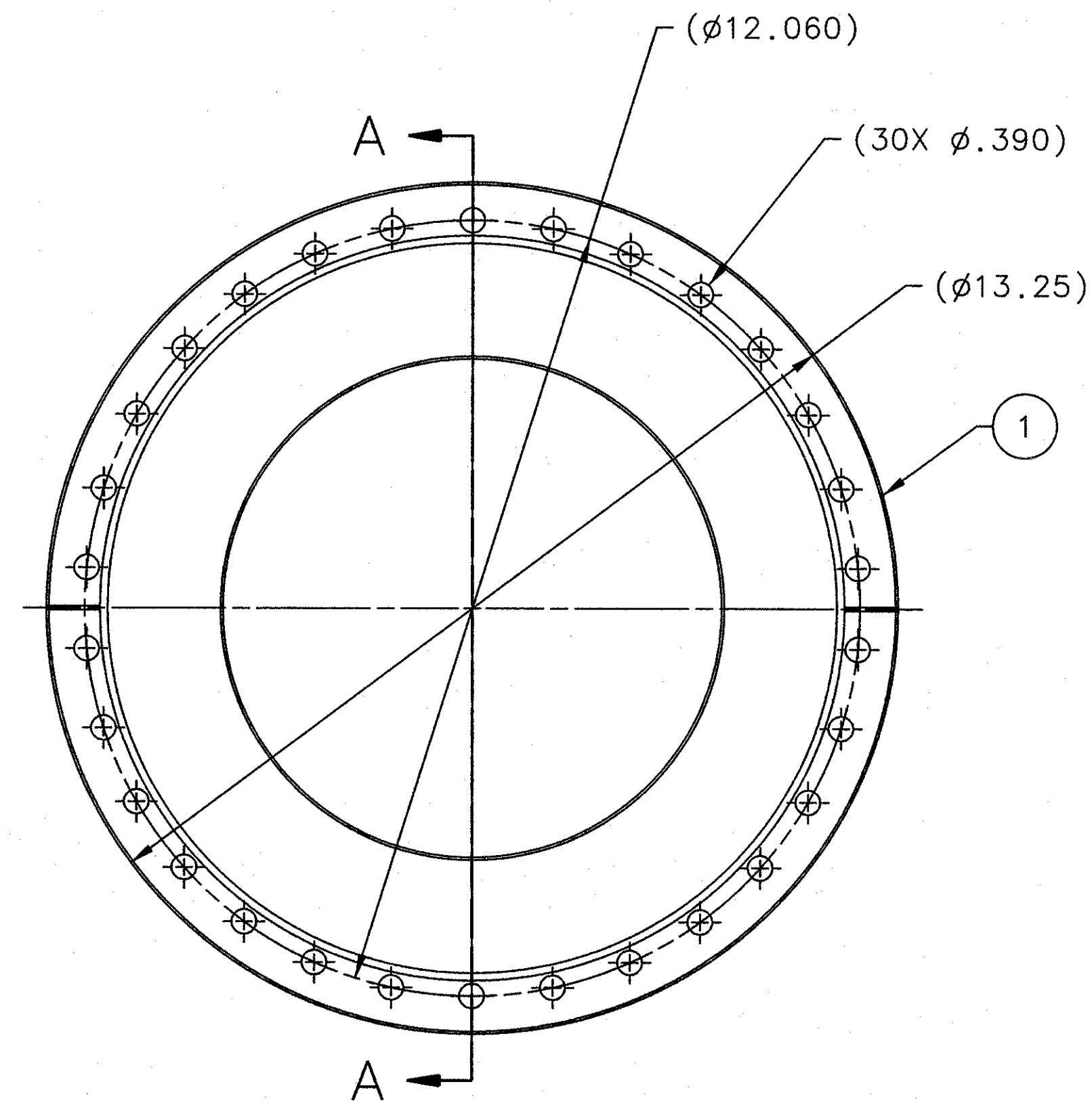

SECTION A-A
SCALE 1:1

NOTES:

- THE FOLLOWING JLAB SPECIFICATIONS APPLY:
 FABRICATION OF UHV EQUIPMENT : : : 22631-S-001 REV B
 CLEANING AND HANDLING OF UHV COMPONENTS : : : 22632-S-001 REV E
- SUGGESTED SOURCE OR JLAB APPROVED EQUIVALENT:
 A. MDC VACUUM PROD. (800)443-8817 www.mdcvacuum.com

D
C
B
A

D
C
B
A

1	1	MDC PART No. 100034.	DEL-SEAL CF 13.25 OD, CLEARANCE, R, BLANK	STAINLESS STEEL TYPE 304	2A
QTY REQD	ITEM NO.	PART OR IDENTIFYING NO.	NOMENCLATURE OR DESCRIPTION	MATERIAL SPECIFICATION	NOTES
PARTS LIST					
DOCUMENT CONTROL STAMP		DIM & TOL PER ASME Y14.5 - UNLESS OTHERWISE SPECIFIED DIMENSIONS ARE IN INCHES. TOLERANCES ARE: FRACTIONS: X ± .1, XX ± .01, XXX ± .005 DECIMAL: ± .005 ANGLES: ± .50°		TRACKING NO. N/A	
MATERIAL SEE PARTS LIST		THIRD ANGLE PROJECTION		APPROVALS DATE	
FINISH MACHINED SURFACES 125 UNLESS OTHERWISE NOTED DEBURR & BREAK ALL SHARP EDGES		DO NOT SCALE DRAWING		APPROVED: <i>[Signature]</i> 3 Nov 11	
United States Department of Energy			Jefferson Lab Office of Jefferson National Accelerator Facility Newport News Virginia		
HALL D GLUE-X BEAMLINE COLLIMATOR ALCOVE FLANGE CF 13.25 OD, R, MODIFIED			DATE: 04NOV08		
SIZE DWG. NO. D00000-02-01-2003			REV. -		
SCALE 1:1			USED ON ASSY NO. D00000-02-01-1000 SHEET 1 OF 1		

8 7 6 5 4 3 2 1