

| REVISION HISTORY | | | | |
|------------------|-----|-------------|------|----------|
| ZONE | REV | DESCRIPTION | DATE | APPROVED |
| | | | | |

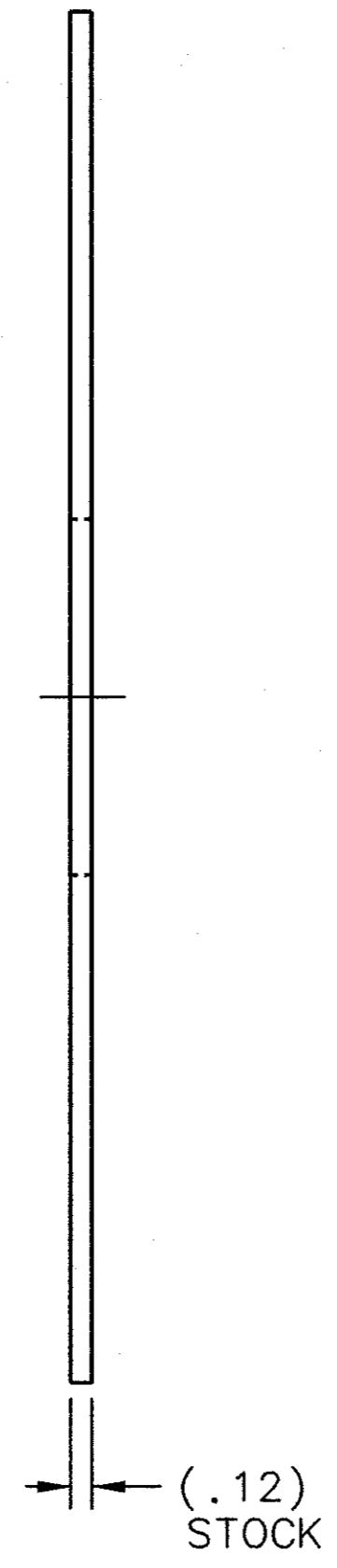
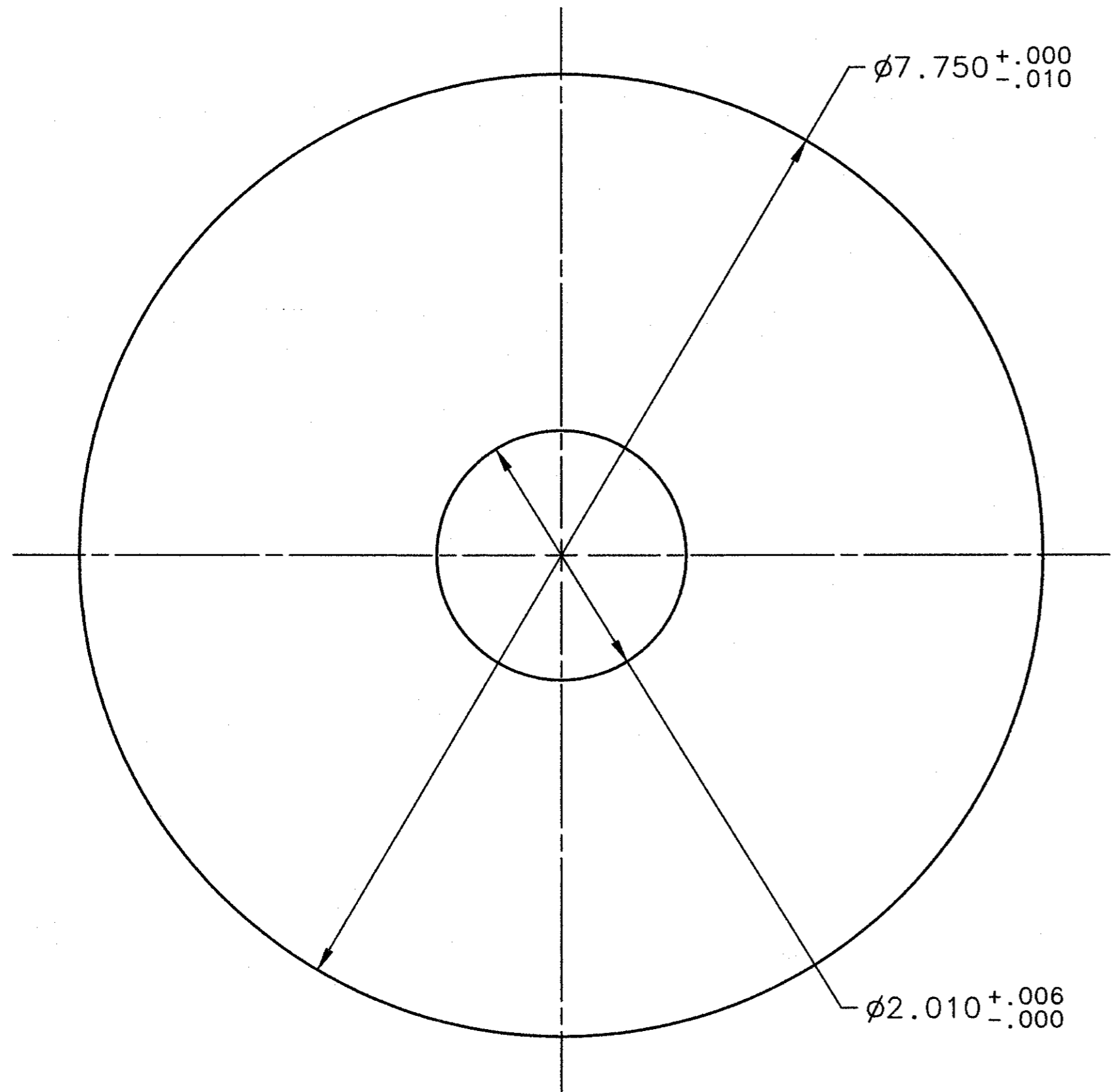

| | | | | |
|---|---|--|---|--|
| DOCUMENT CONTROL STAMP | DIM & TOL PER ASME Y14.5 . UNLESS OTHERWISE SPECIFIED DIMENSIONS ARE IN INCHES TOLERANCES ARE: FRACTIONS DECIMAL ANGLES \pm N/A .X \pm .1 \pm .50° .XX \pm .01 .XXX \pm .005 | TRACKING NO. N/A | | United States Department of Energy Jefferson National Accelerator Facility Newport News Virginia |
| | | APPROVALS | DATE | |
| MATERIAL: STAINLESS STEEL TYPE 304 SHEET .12 THK | THIRD ANGLE PROJECTION | DRAWN R. GETZ | 5APR11 | SIZE DWG. NO. C D00000-02-01-2045 |
| FINISH MACHINED SURFACES 125 UNLESS OTHERWISE NOTED DEBURR & BREAK ALL SHARP EDGES | | CHECKED <i>[Signature]</i> 4 Nov 11 | APPROVED <i>[Signature]</i> 4 Nov 11 | |
| DO NOT SCALE DRAWING | | APPROVED <i>[Signature]</i> 08 Nov 11 | SCALE 1:1 | USED ON ASSY NO. D00000-02-01-1007 SHEET 1 OF 1 |