

REVISION HISTORY				
ZONE	REV	DESCRIPTION	DATE	APPROVED
-	A	PARTS ITEM 2 & 3 SHIFTED. REF. DIM'S .13 & .41 ADDED. VGR 19JUN13		R.GETZ T.WHITLATCH

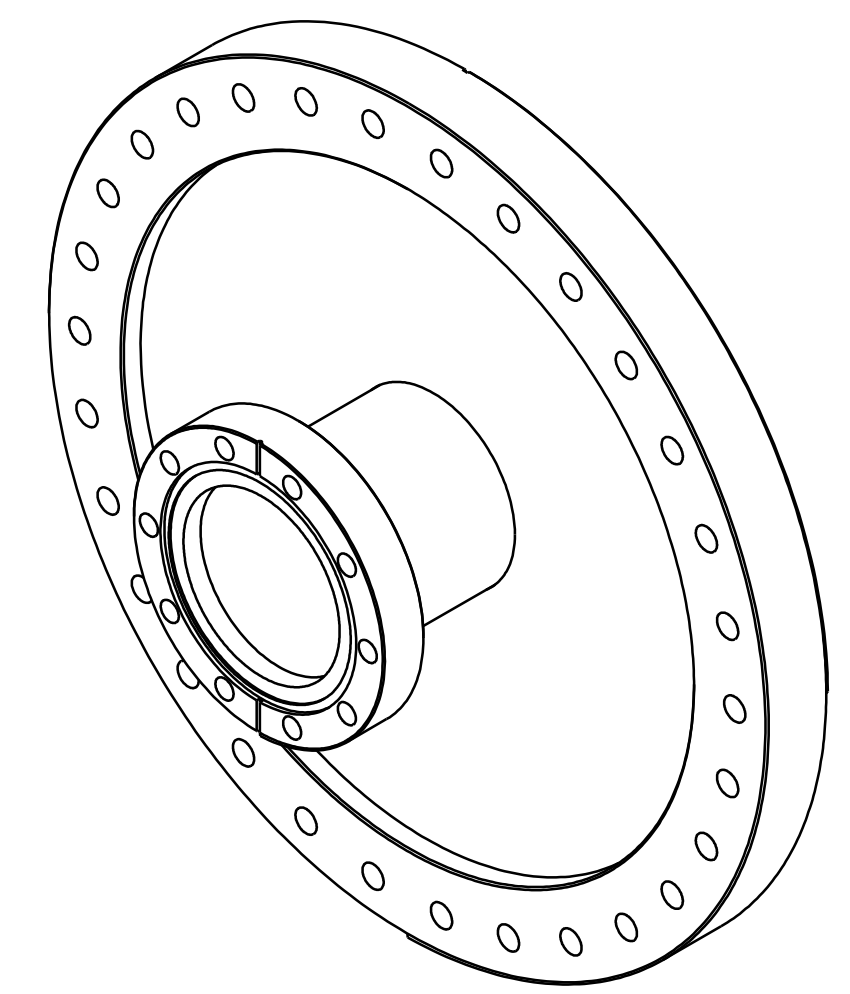
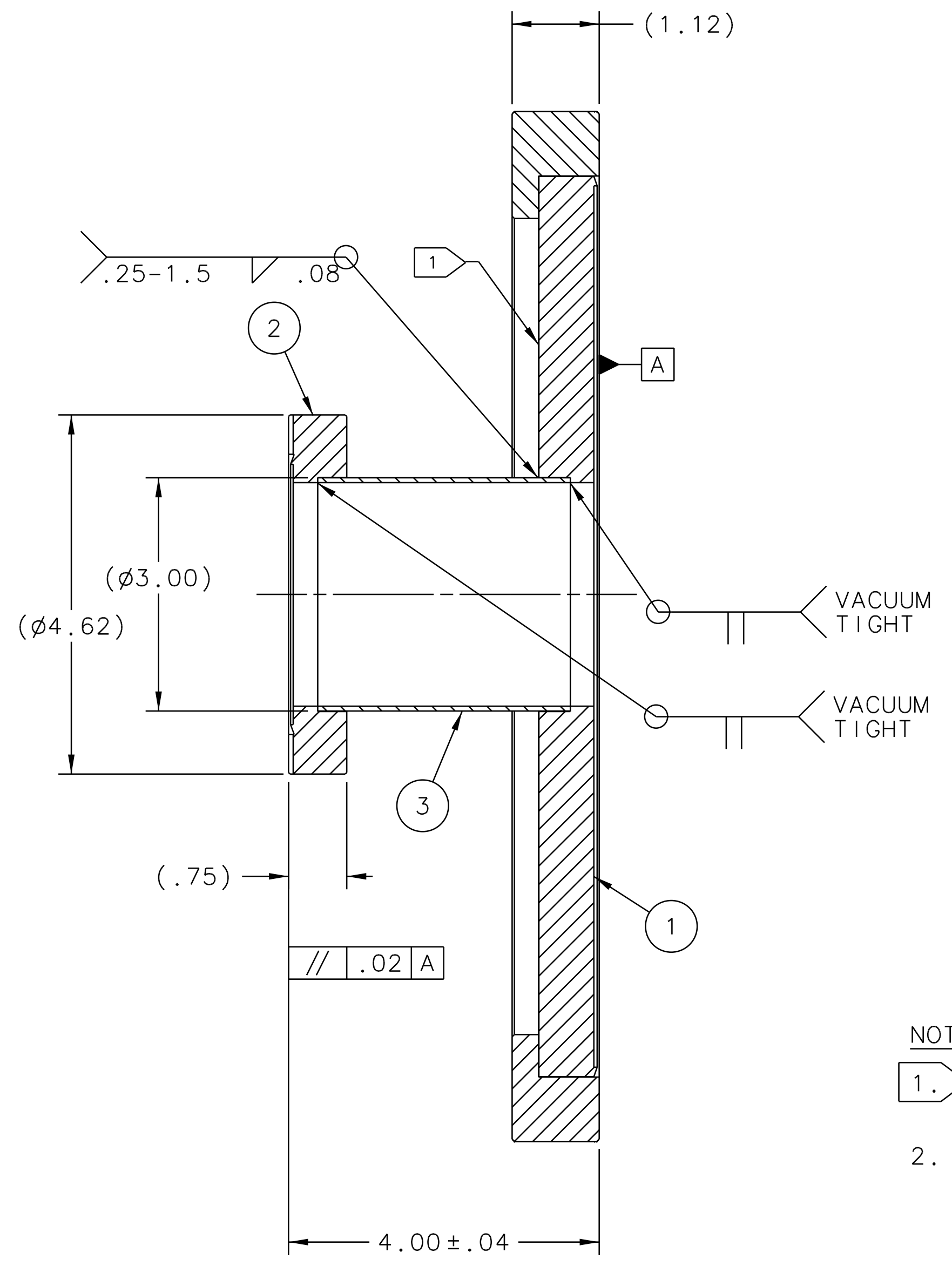
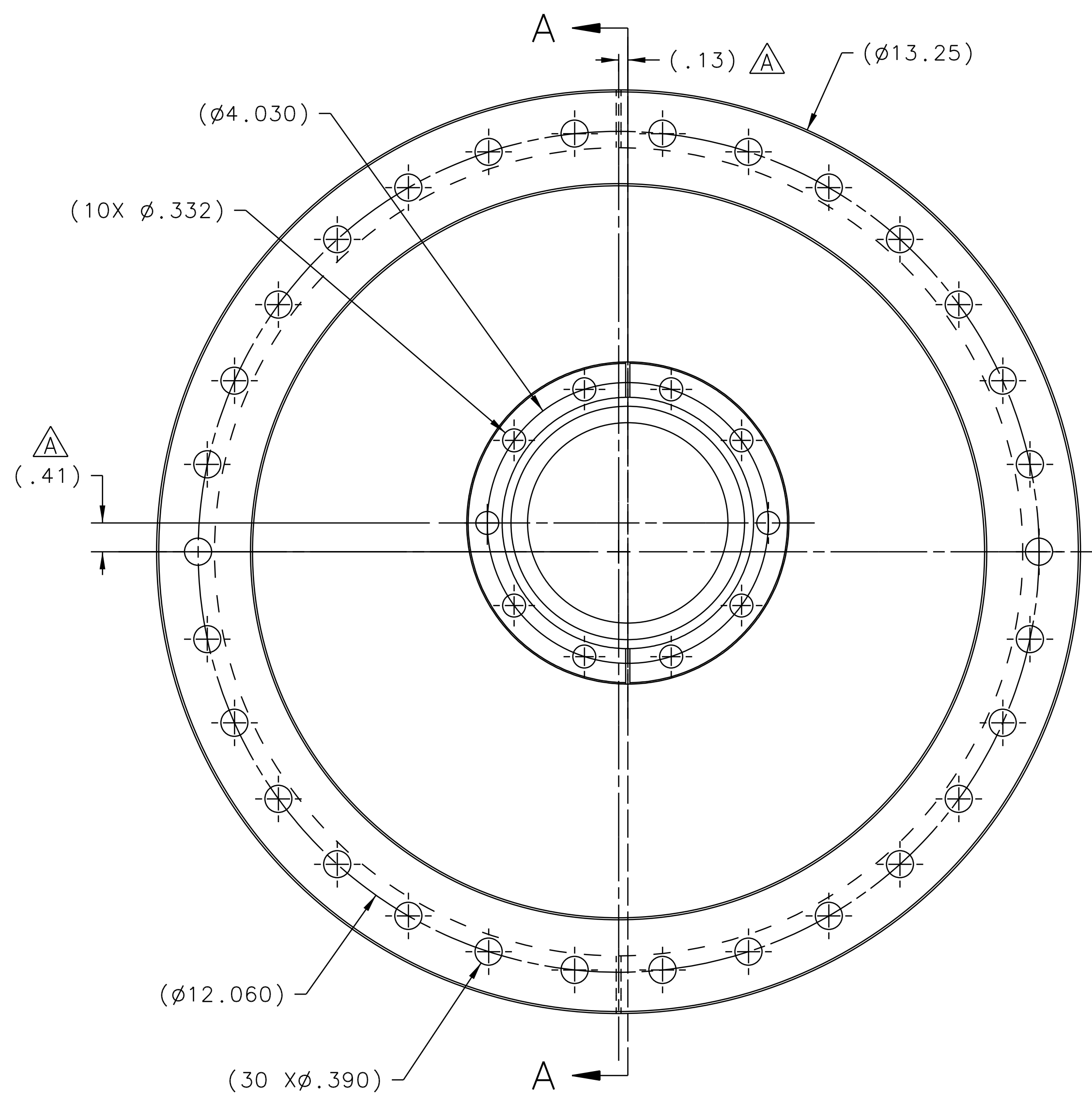

ISOMETRIC VIEW  
SCALE: 1:2.5

NOTES:

- STENCIL "D00000-02-02-1005" AND "WEIGHT APPROX. 39 LBS" AT APPROX. LOCATION SHOWN IN .25" MIN. CHARACTERS. BLACK PAINT.
- THE FOLLOWING JLAB SPECIFICATIONS APPLY:  
 FABRICATION OF UHV EQUIPMENT ... 22631-S-001 REV.B  
 CLEANING AND HANDLING OF UHV COMPONENTS ... 22632-S-001 REV.E  
 WELDING SPECIFICATION FOR UHV COMPONENTS ... 22633-S-001 REV.A  
 HELIUM LEAK TEST PROCEDURE FOR UHV COMP ... 22634-S-001 REV.A
- CERTIFICATION OF MATERIAL MUST BE ACCOMPANIED WITH DELIVERY.
- SUGGESTED SOURCE OR JLAB APPROVED EQUIVALENT:  
 A. MDC VACUUM PROD. (800)443-8817 www.mdcvacuum.com

QTY REQD	ITEM NO.	PART OR IDENTIFYING NO.	NOMENCLATURE OR DESCRIPTION	MATERIAL SPECIFICATION	NOTES
1	3		TUBE 3.0 OD X .065 WALL THK	STAINLESS STEEL 304	
1	2	MDC # 110024	VAC. FL. 4.62 CF-NR X 3.01 BORE	STAINLESS STEEL 304	
1	1	D00000-02-02-2006	VAC. FL.13.25CF-R X 3.01 BORE		

FOR JLAB INTERNAL USE ONLY		DOCUMENT CONTROL STAMP		DIM & TOL PER ASME Y14.5 UNLESS OTHERWISE SPECIFIED DIMENSIONS ARE IN INCHES		TRACKING NO. N/A		United States Department of Energy		Jefferson Lab Thomas Jefferson National Accelerator Facility Newport News Virginia	
ALL WELDS ON THIS DRAWING ARE AS DEFINED BY JLAB ES & H MANUAL, WELDING & BRAZING PROGRAM SUPPLEMENT				TOLERANCES ARE: FRACTIONS DECIMAL ANGLES ± N/A .X ± .1 ± .50° .XX ± .02 .XXX ± .01		APPROVALS		DATE		HALL D GLUE-X BEAMLINE TAGGER AREA NIP. RED.13.25CF-R X 4.62CF ASSY	
WELD CLASS	WELD SPECIFICATION SEE NOTE 2	MATERIAL SEE PARTS LIST		THIRD ANGLE PROJECTION		DRAWN VGR		6AUG12		SIZE DWG. NO. D D00000-02-02-1005	
C	WELD ANALYSIS N/A	FINISH 125 UNLESS OTHERWISE NOTED MACHINED SURFACES DEBURR & BREAK ALL SHARP EDGES		DO NOT SCALE DRAWING		CHECKED R.GETZ				REV. A	
						APPROVED R.GETZ				SCALE 3:4	
						APPROVED T.WHITLATCH				USED ON ASSY NO. D00000-00-02-1006 SHEET 1 OF 1	