

**Upper CB Adsorber Heater A Terminal
Enclosure (CXU-TB1)
(15-5032-1411-A)**

<p>Written by: Cold Box Manufacturer: PHPK</p>	<p><u>Distribution :</u></p> <p>JLAB AL project team</p>
<p>Reviewed by Technical Manager: Gilles Flavien gilles.flavien@airliquide.com</p>	

MODIFICATIONS RECORDING

ISSUE OF MODIF	DATE	WRITTEN BY	CHECKED BY	EVOLUTION OF THE DOCUMENT (Updated pages)	JUSTIFICATION OF THE MODIFICATION
<p>Note: Recording of modifications are included in document</p>					

CXU-TB1 HEATER TERMINAL BOX

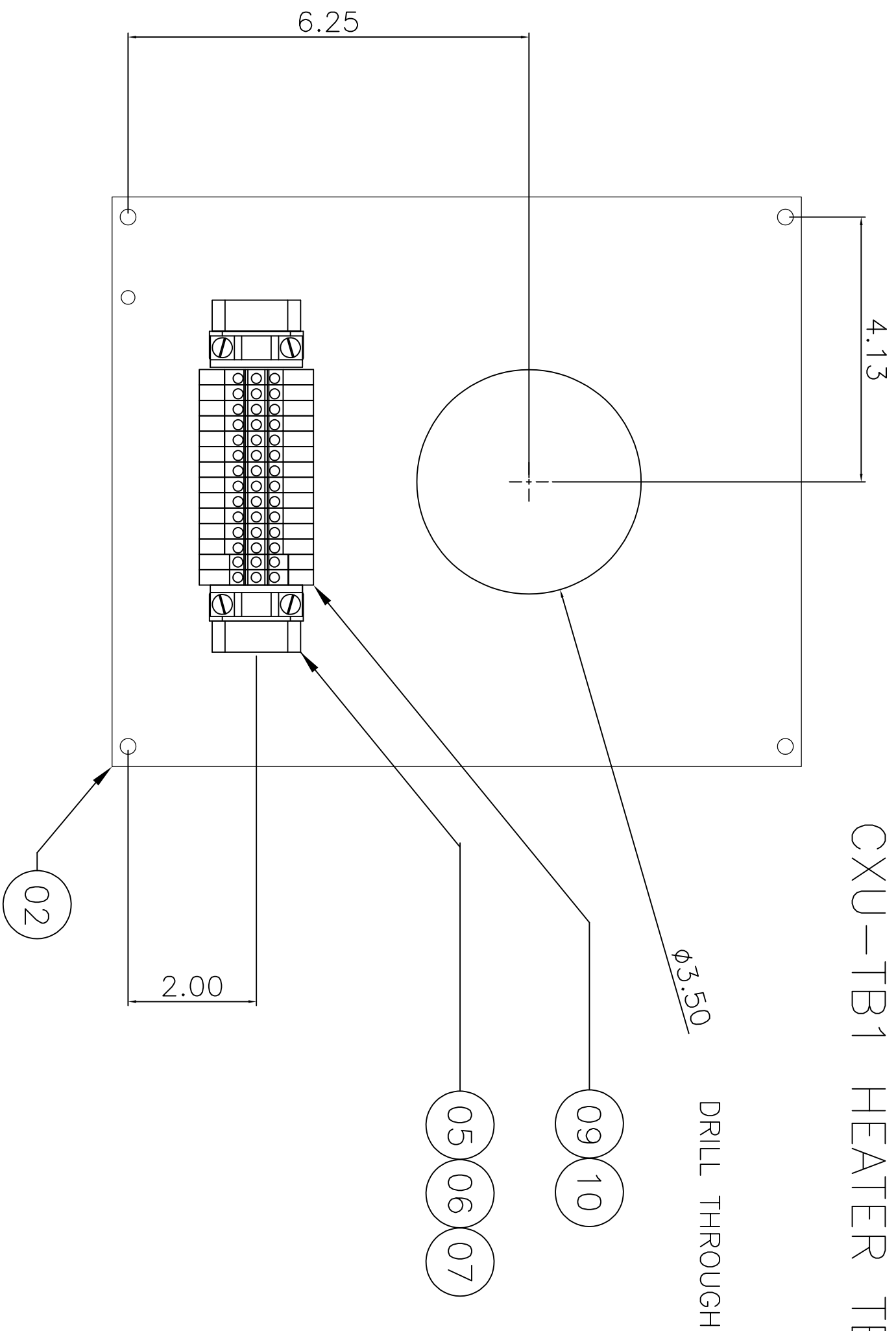

BACKPANEL DRILL DIAGRAM AND TERMINAL
BLOCK LOCATION

C1U-TB1 NUMBERING LEFT TO RIGHT		C2U-TB1 NUMBERING LEFT TO RIGHT	
C1U201	C2U201		
C1U202	C2U202		
C1U203	C2U203		
C1U204	C2U204		
C1U205	C2U205		
C1U206	C2U206		
C1U251	C2U251		
C1U252	C2U252		
C1U253	C2U253		
C1U254	C2U254		
C1U255	C2U255		
C1U256	C2U256		
GND	GND		
GND	GND		

REVISIONS						DESCRIPTION
CHG.	DATE	DWN.	CH'KD.	ENGR.	REV'D	
-	-	-	-	-	-	-

. LBS WEIGHT DRAWN CHECKED ENGINEER REVIEWED		WORK ORDER MJA SPW MJA SPW		CONTRACT NO. TOLERANCES FRACTION .XX .XXX ANGULAR		REL. DATE 8/30/2016		DIMENSIONS ARE PROVIDED PRIOR TO SURFACE TREATMENTS UNLESS NOTED.	
INFORMATION SHOWN ON THIS DRAWING IS PROPRIETARY AND THE SOLE PROPERTY OF PHPK AND IS NOT TO BE DISCLOSED OR TRANSMITTED TO UNAUTHOR- IZED PARTIES.				TITLE CXU-TB1 UPPER COLD BOX TERMINAL BOX 1		LOTS II		CHG.	
PHPK TECHNOLOGIES 2111 BUILDERS PLACE COLUMBUS, OHIO 43204		DRAWING NO. 15-5032-1411		NO. REC'D 2		NEXT ASSEMBLY SIZE		SHEET 1 OF 4	
SIZE B		SCALE NONE		CHG. A		SHEET 1 OF 4		SHEET 1 OF 4	

REVISIONS

CHG.	DATE	DWN.	CH'KD.	ENGR.	REV'D	DESCRIPTION
-	-	-	-	-	-	-

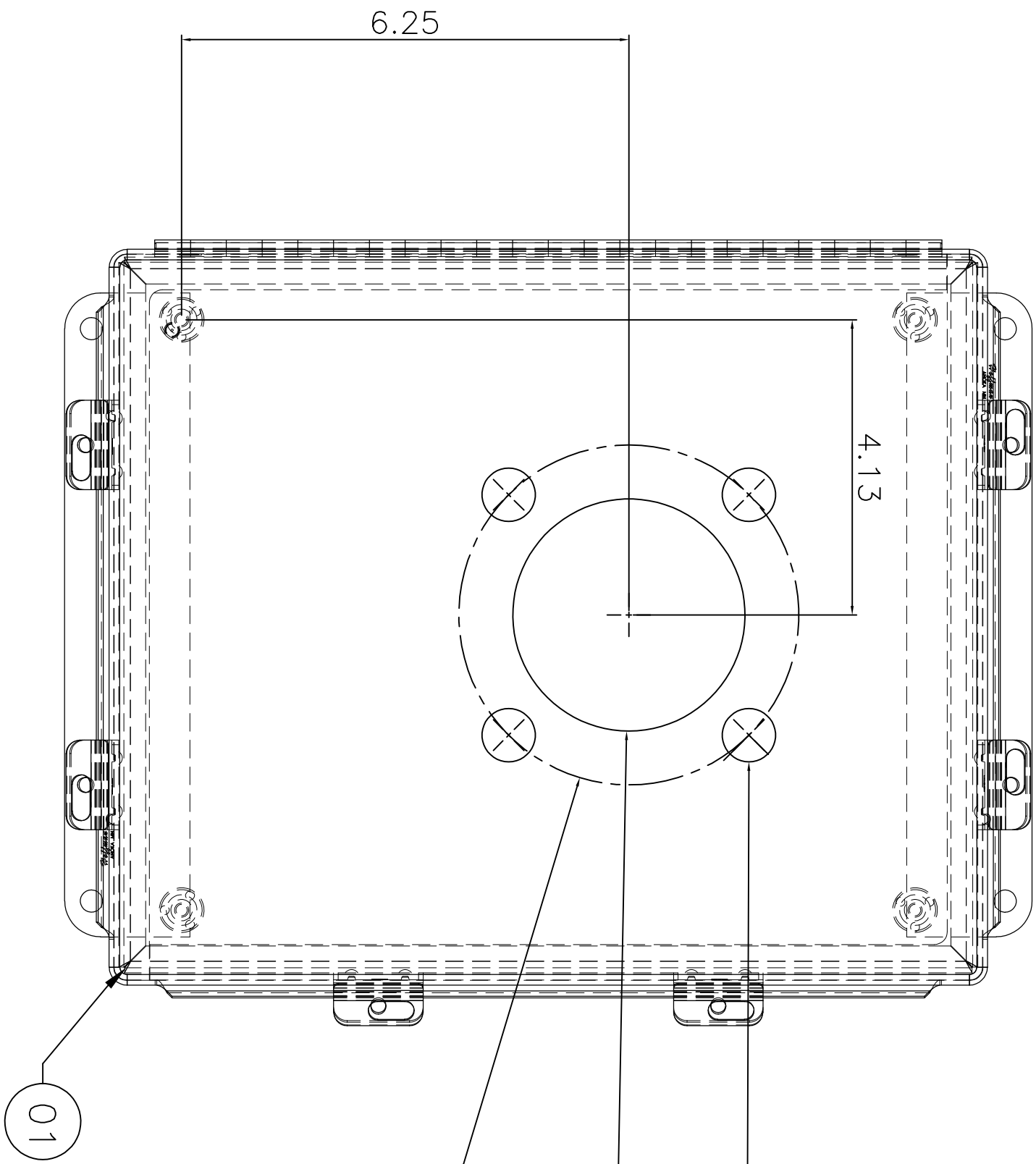

Ø0.75 DRILL THROUGH 4X
EVENLY SPACED

Ø3.25 DRILL THROUGH

Ø4.75

HOLE CENTERLINE

ENCLOSURE DRILL DIAGRAM (BACK OF
ENCLOSURE ONLY, DOOR NOT SHOWN)

INFORMATION SHOWN ON THIS
DRAWING IS PROPRIETARY AND
THE SOLE PROPERTY OF PHPK
AND IS NOT TO BE DISCLOSED
OR TRANSMITTED TO UNAUTHOR-
IZED PARTIES.

. LBS	WORK ORDER	CONTRACT NO.	PART NUMBER	NO. REC'D	NEXT ASSEMBLY	SIZE
	MJA			2		
WEIGHT						
DRAWN	MJA	TOLERANCES				
CHECKED	SPW	FRACTION				
ENGINEER	MJA	.XX				
REVIEWED	SPW	.XXX				
		ANGULAR				
REL. DATE	8/30/2016					
DIMENSIONS ARE PROVIDED PRIOR TO SURFACE TREATMENTS UNLESS NOTED.						
TITLE			LCS II			
2111 BUILDERS PLACE COLUMBUS, OHIO 43204			CXU-TB1 UPPER COLD BOX TERMINAL BOX 1			
PHPK TECHNOLOGIES			DRAWING NO. 15-5032-1411			
SIZE B			SCALE NONE			
CHG. A			SHEET 2 OF 4			

REVISIONS

CHG.	DATE	DWN.	CH'KD.	ENGR.	REV'D	DESCRIPTION
-	-	-	-	-	-	

NO. REC'D.	ITEM	DESCRIPTION	NOTE
-1	01	COM'L ELECTRICAL ENCLOSURE - "HOFFMAN", A1210GHNF	
1	02	COM'L BACKPANEL - "HOFFMAN", A12P10	
1	03	COM'L FEEDTHROUGH, DOUGLAS, 14 WIRE, TEFLON, 12 AWG 2.75" CONFLAT FLANGE (PHPK SUPPLIED)	PHPK SUPPLY, LENGTH TBD
1	04	COM'L PLASTIC BLACK ON WHITE TAGS SIZED TO FIT, ENGRAVED AS SHOWN	
12	05	COM'L TERMINAL, RED, 1 CIRCUIT "ALLEN BRADLEY" # 1492-J4-RE	
2	06	COM'L TERMINAL, RED, 1 CIRCUIT "ALLEN BRADLEY" # 1492-J4-RE	
2	07	COM'L ANCHORS "ALLEN BRADLEY" # 1492-EAH35	
4	08	COM'L THREADED STANDOFF, MCMASTER CARR 92700A018	
2	09	COM'L TERMINAL, GROUNDING, "ALLEN BRADLEY" # 1492-WMG4	
2	10	COM'L PARTITIAN PLATE, "ALLEN BRADLEY" # 1492-PPM3	
	11		
	12		
	13		
	14		
	15		
	16		
	17		
	18		
	19		
	20		
	21		
	22		
	23		
	24		
	25		

BILL OF MATERIAL

NOTES:

- TAGS ITEM #4 ENGRAVED:
 "C1U-TB1"
 "C2U-TB1"

INFORMATION SHOWN ON THIS DRAWING IS PROPRIETARY AND THE SOLE PROPERTY OF PHPK AND IS NOT TO BE DISCLOSED OR TRANSMITTED TO UNAUTHORIZED PARTIES.

REL. DATE	8/30/2016	WORK ORDER	MJA	CONTRACT NO.		PART NUMBER		NO. REC'D	2	NEXT ASSEMBLY		SIZE	
ENGINEER	MJA	SPW		FRACTION	.XX	PHPK TECHNOLOGIES 2111 BUILDERS PLACE COLUMBUS, OHIO 43204 LCIS II CXU-TB1 UPPER COLD BOX TERMINAL BOX 1							
ENGINEER	MJA	SPW		ANGULAR		TITLE: CXU-TB1 UPPER COLD BOX TERMINAL BOX 1 DRAWING NO.: 15-5032-1411 SIZE: B SCALE: NONE							
REVIEWED	SPW	ANGULAR				CHG. A							
REL. DATE	8/30/2016	DIMENSIONS ARE PROVIDED PRIOR TO SURFACE TREATMENTS UNLESS NOTED.											