

Electronic boards

Mechanical assembly procedure

**D. Orecchini, V. Lucherini, A. Viticchie',
A. Orlandi, S. Tomassini, M. Mirazita**

Notes and recommendations

- The FE electronics is organized in tiles of three boards: adapter, MAROC and FPGA
- The boards are assembled on the carbon fiber electronic panel following a well defined sequence.
- There are 115 tiles servicing 3 MAPMTs (3x) and 23 tiles servicing 2 MAPMTs (2x)
- The adapter and MAROC boards have two variants (2x and 3x), the FPGA is the same for all the tiles
- The adapter and the MAPMTs are on the side of the panel toward the inside of the RICH, the MAROC and the FPGA on the side toward the outside of the RICH

- Use powder free nitrile gloves during all the phases of the assembly procedure**
- Avoid to touch the glass window of the MAPMTs**
- Secure the nuts by hand, don't use tools**

- The assembly sequence should start from the top row**
- Plugging in the MAPMTs should be last operation of the tile assembly**

Electronic panel mounted on the assembly support

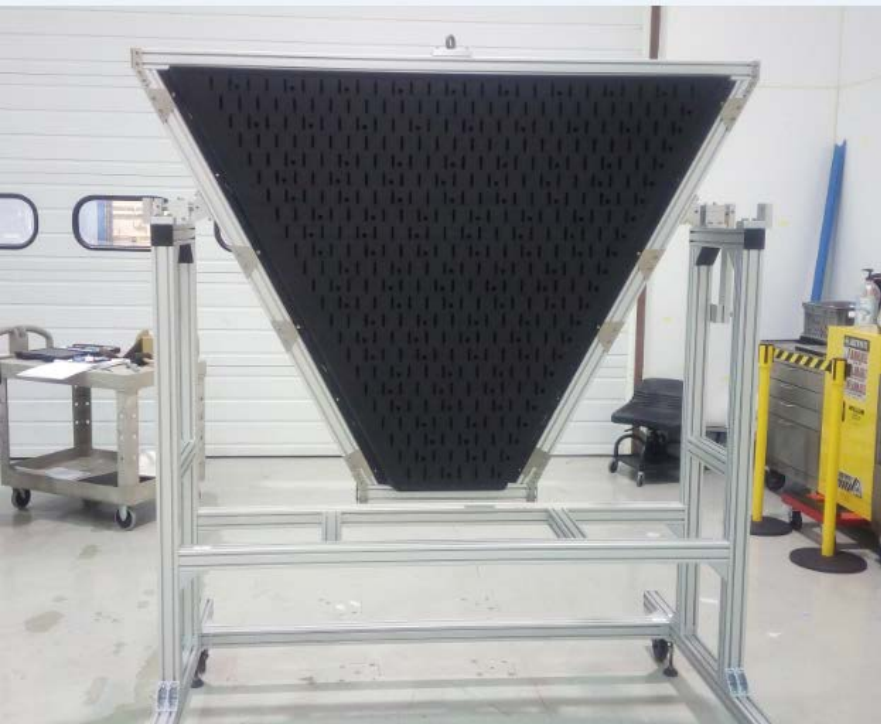

Scheme of the tile assembly on the panel, as seen from the MAPMT side
In yellow are indicated the 2x tiles

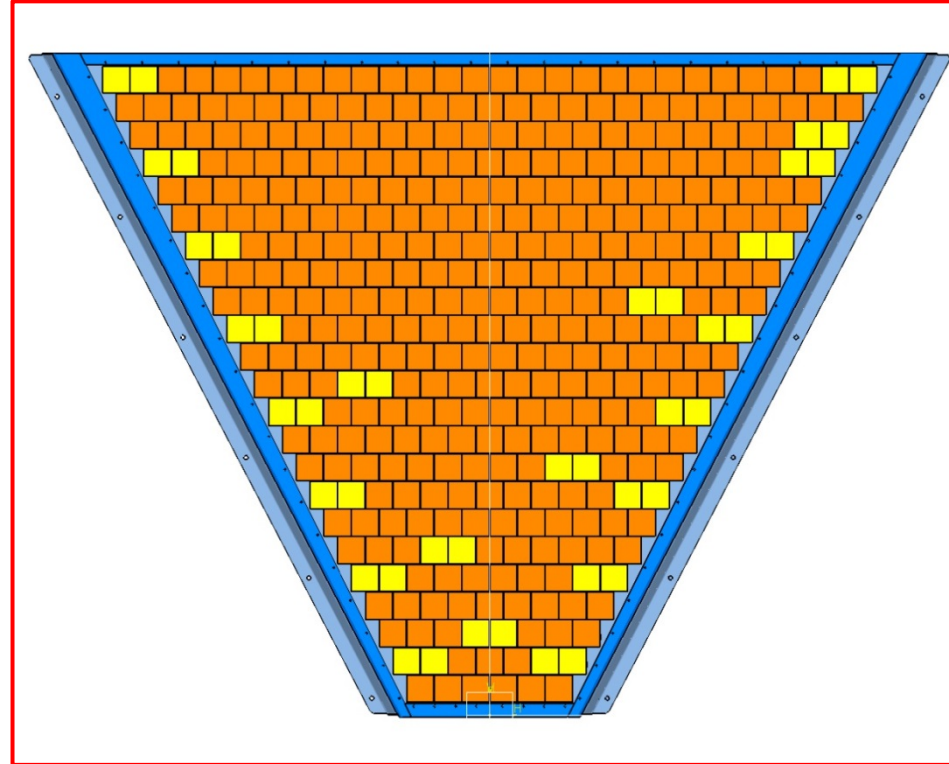

In the following, “inner side” of the electronic panel is the one toward the inside of the RICH, “outer side” is the one toward the outside of the RICH

Elements of the 2x tile

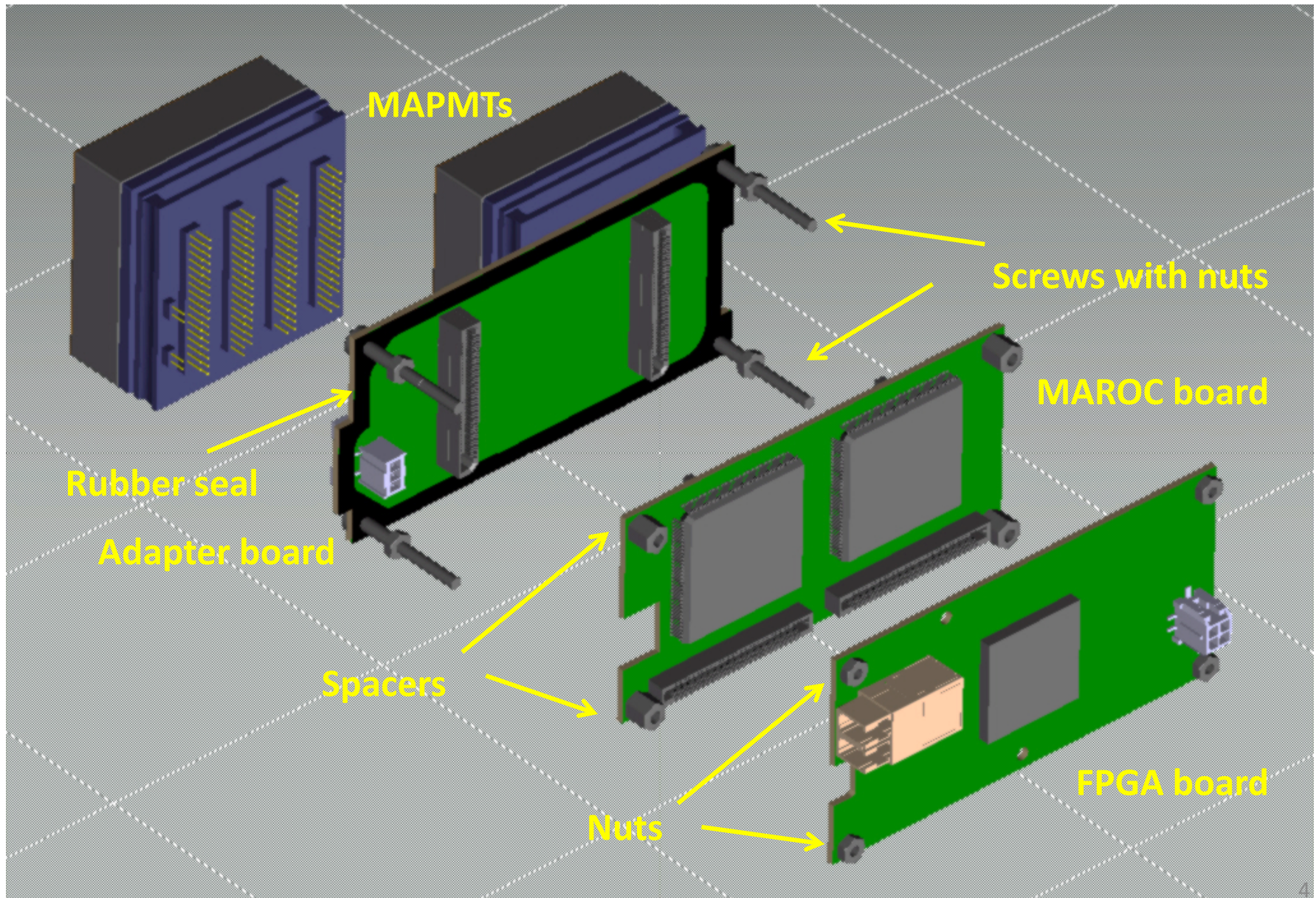

Elements of the 3x tile

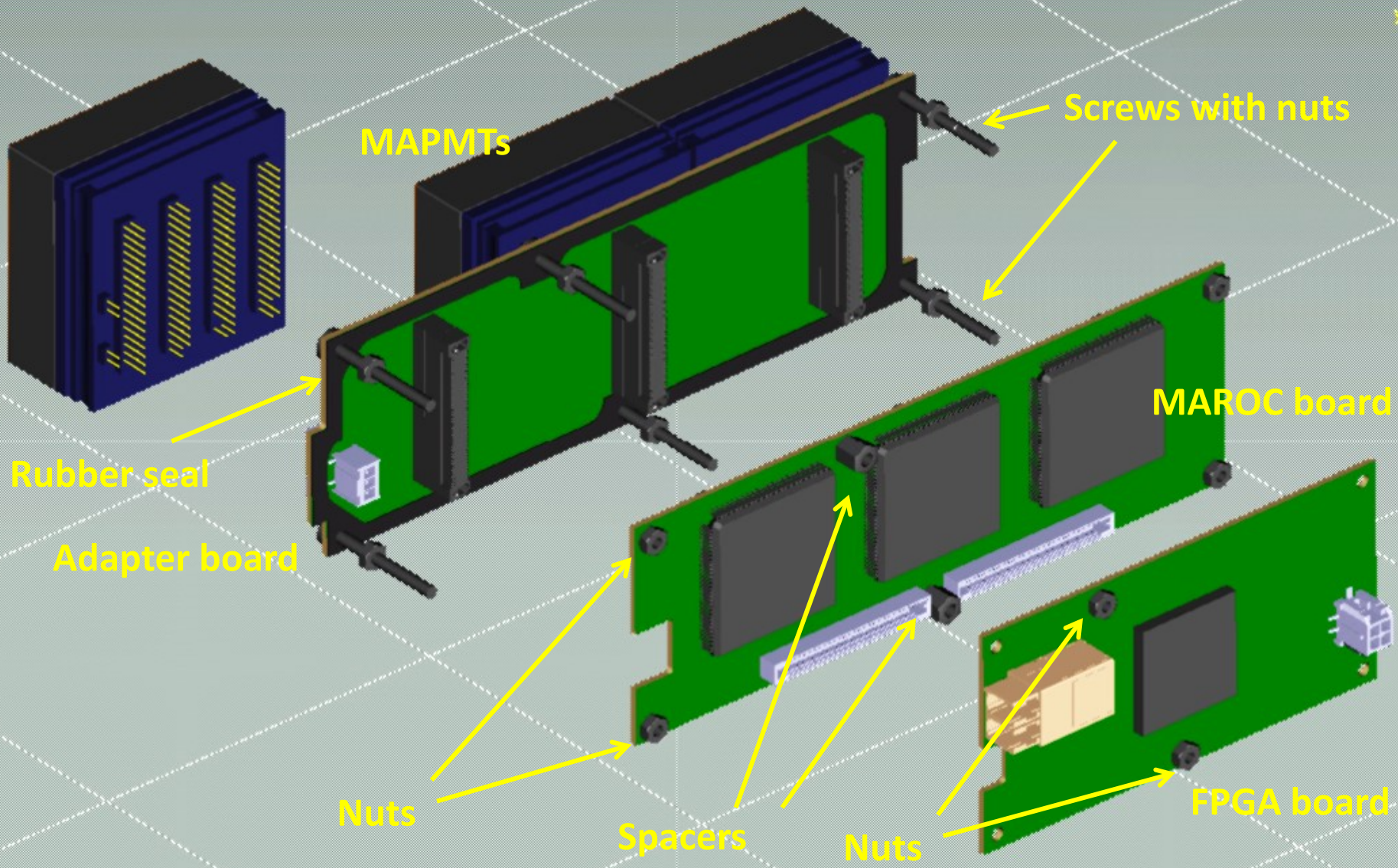

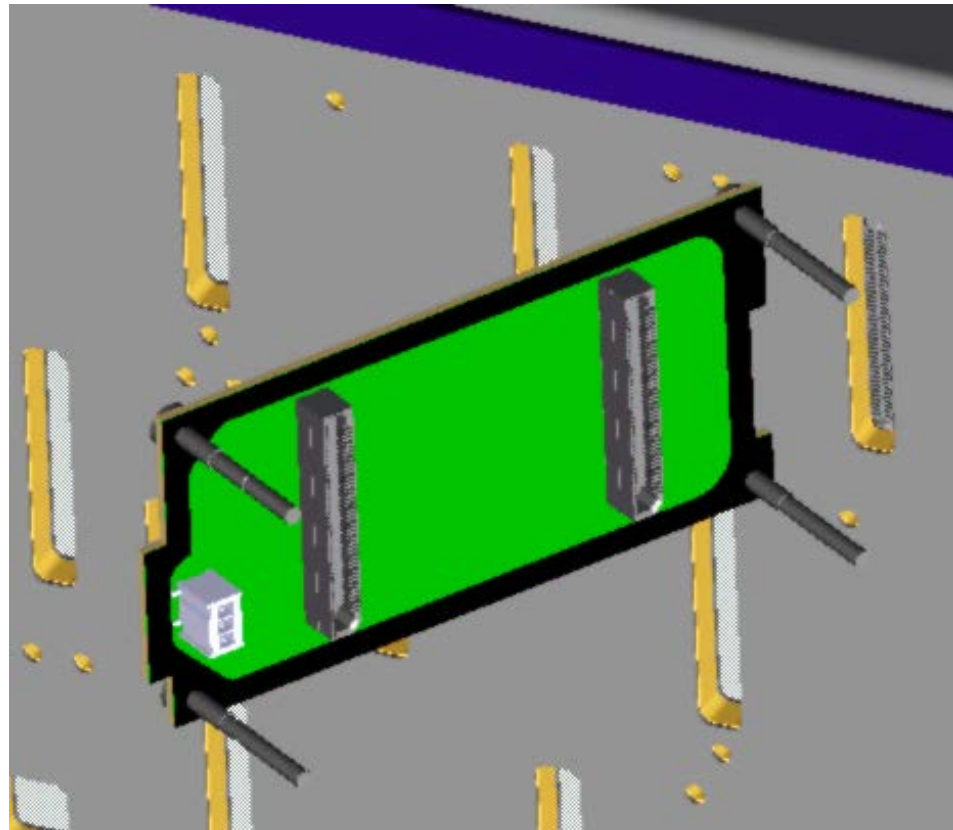

**Insert the screws in the holes of
the adapter board**

**Place the rubber seal on the inner
side of the board**

2x tile

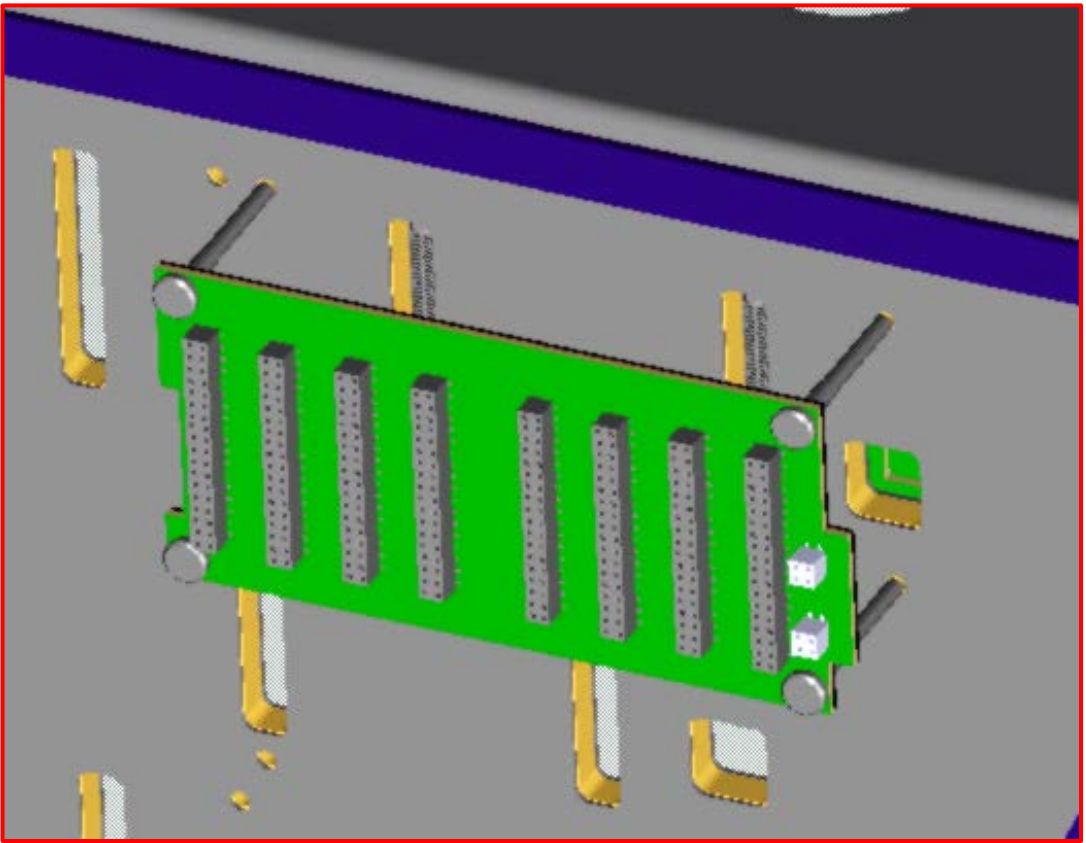

Insert the adapter board with seal on the inner side of the panel

Follow the positions of the holes for the screws and for the HV connectors

2x tile

Screw the nuts on the outer side of the outer side of the panel

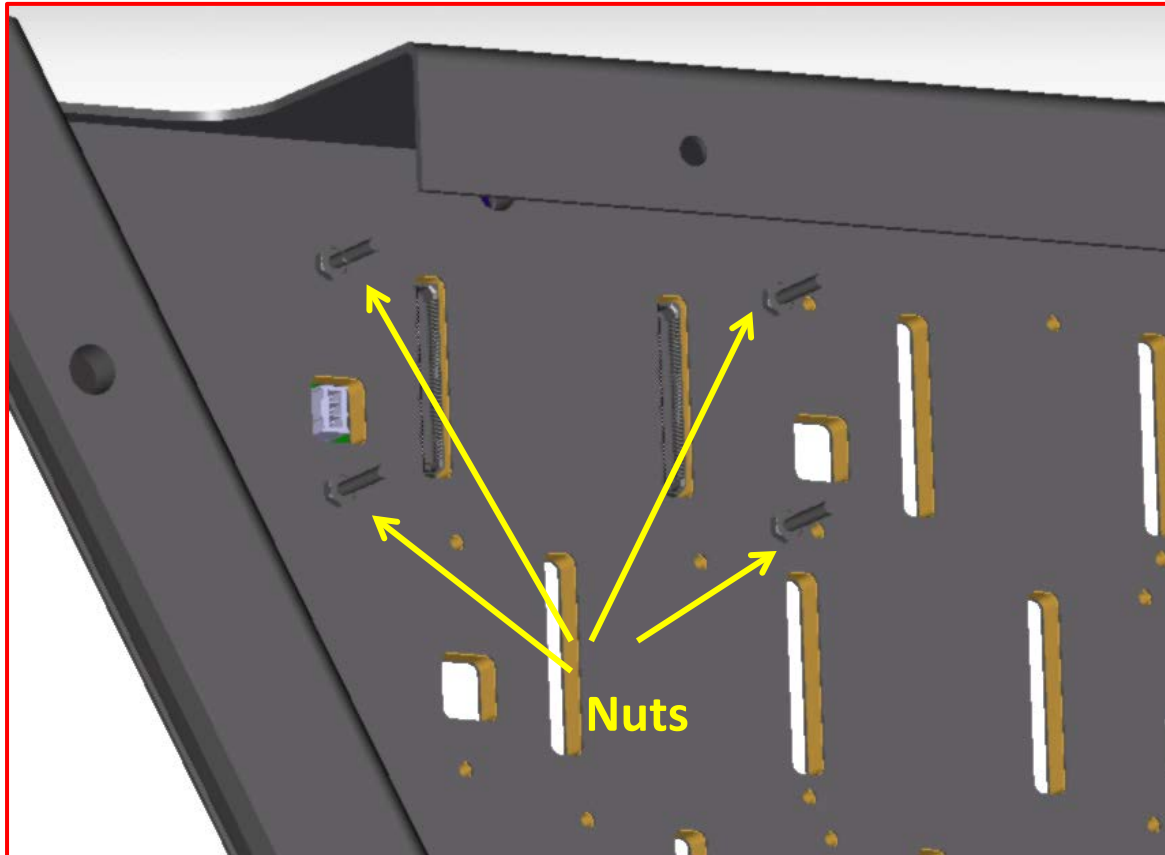

2x tile

Insert the MAROC board in the four screws on the outer side of the electronic panel

Then plug the connectors to the adapter board

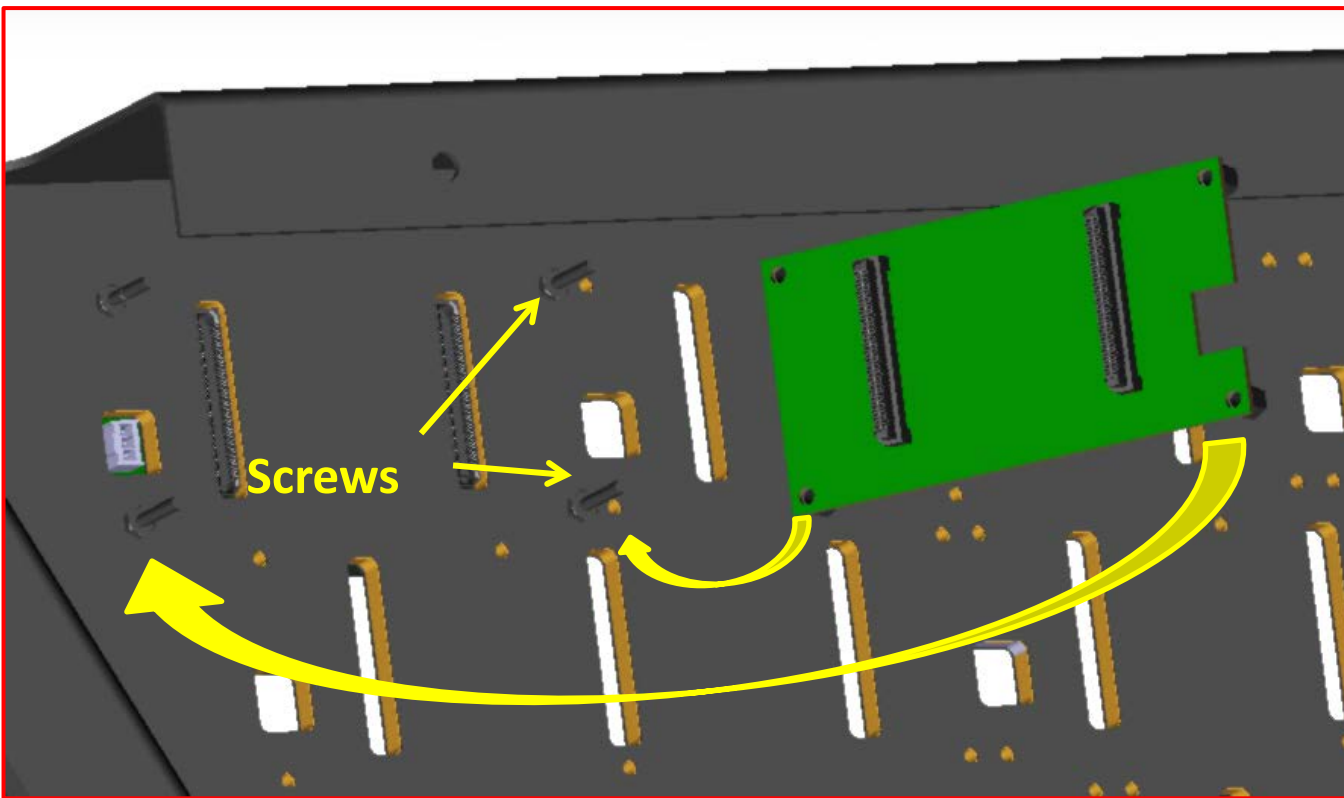

2x tile

Fix the MAROC by using the spacers

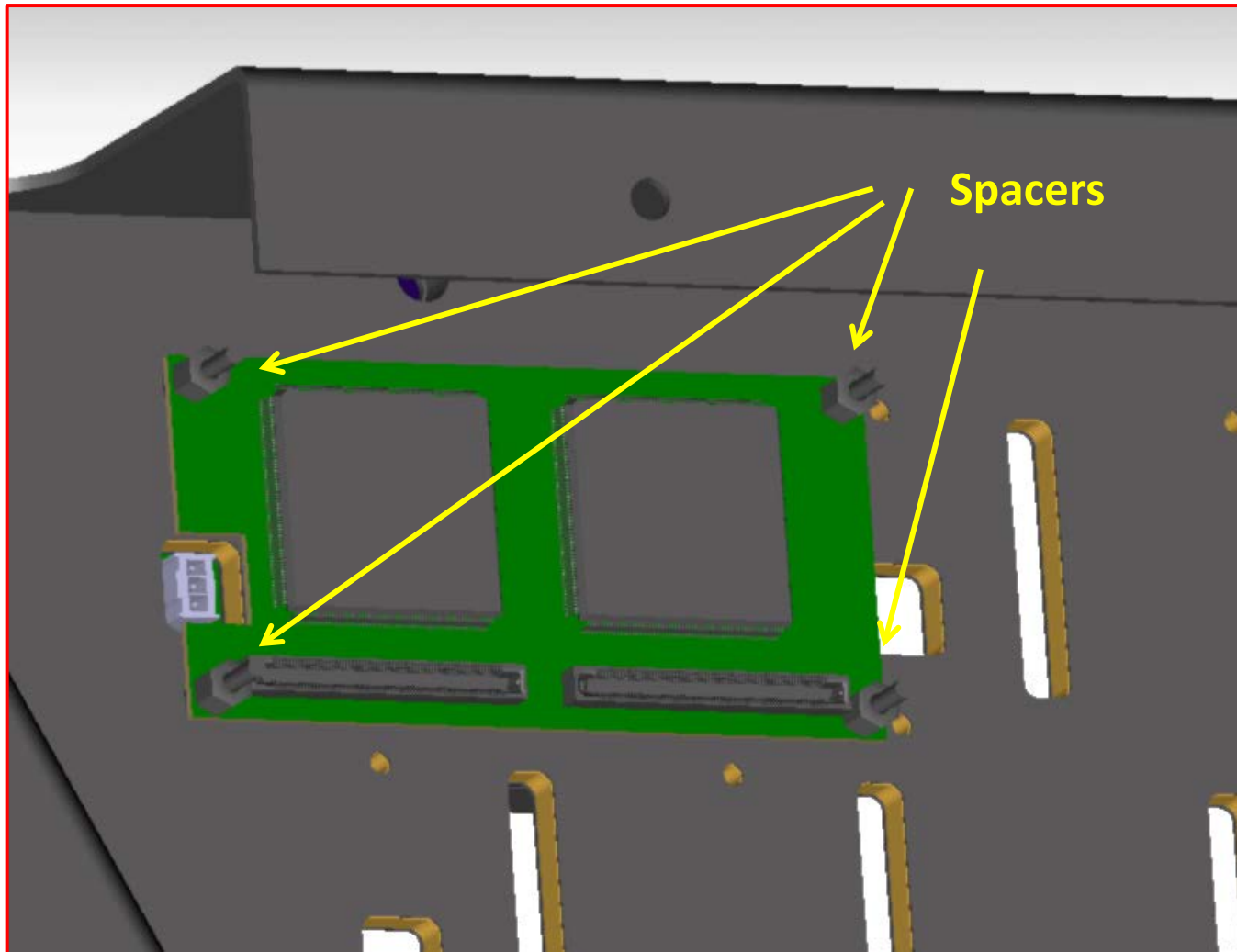

2x tile

Insert the FPGA on the screws

Then plug the connectors to the MAROC board

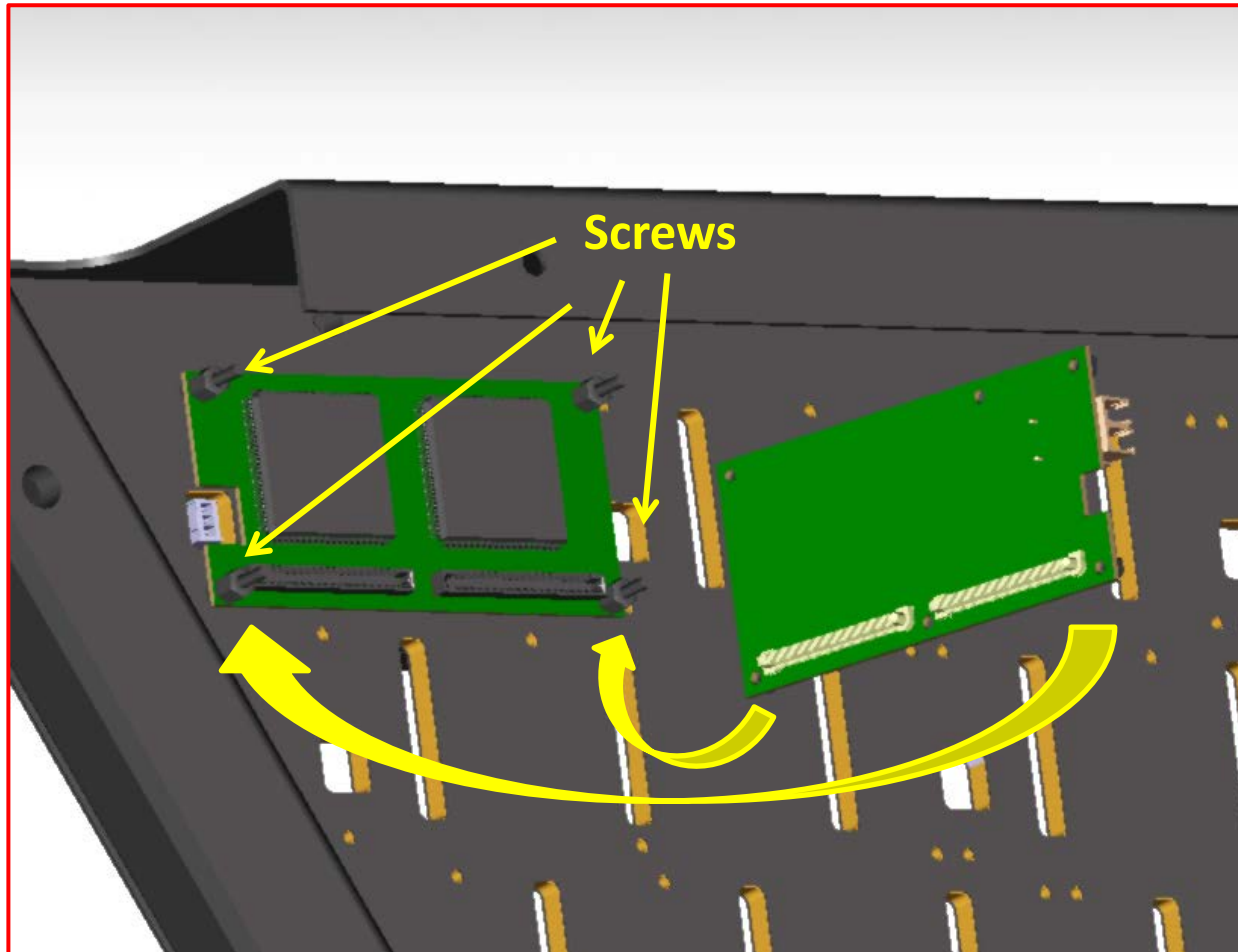

2x tile

Insert the FPGA on the two central screws

Then plug the connectors to the MAROC board

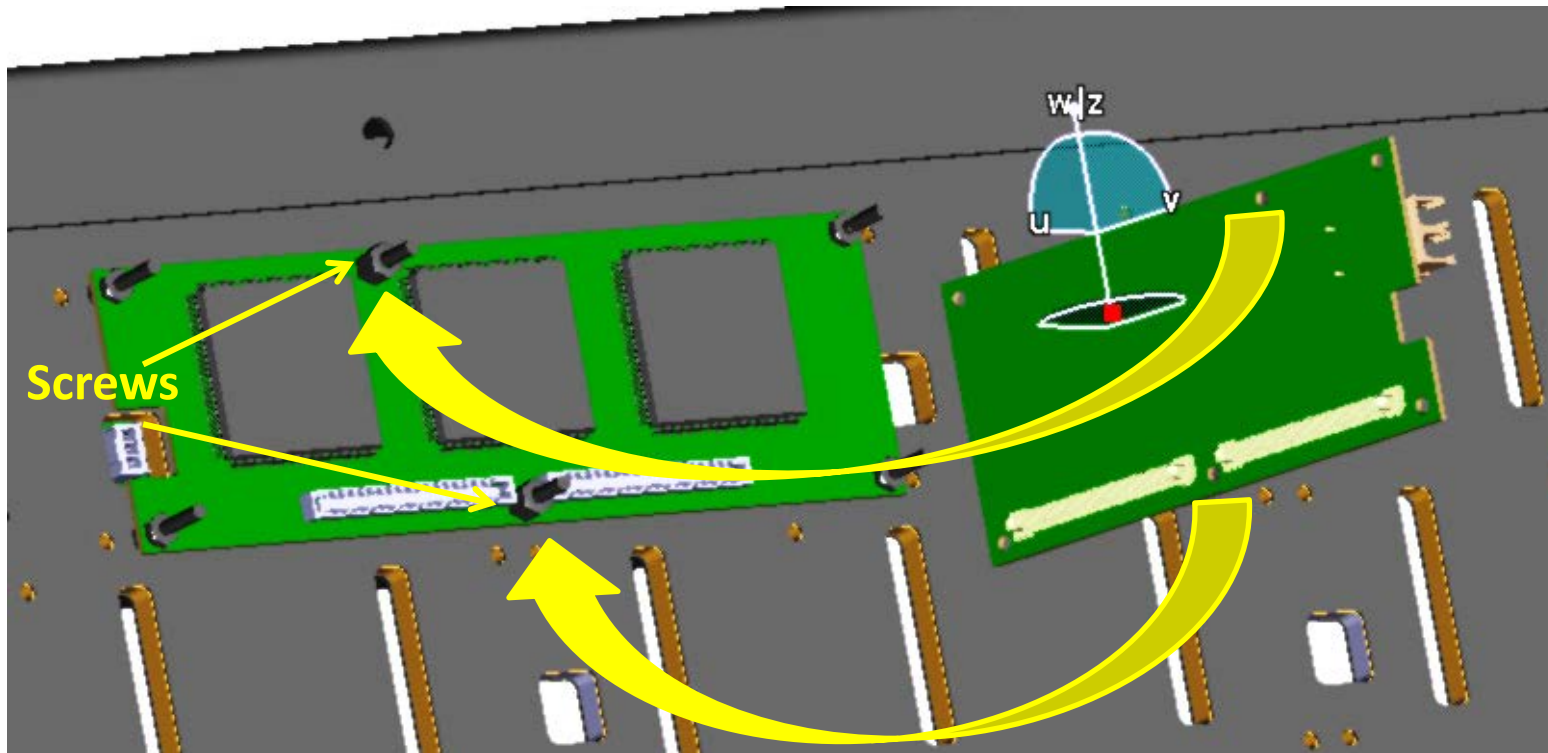

3x tile

Fix the FPGA board with the four nuts

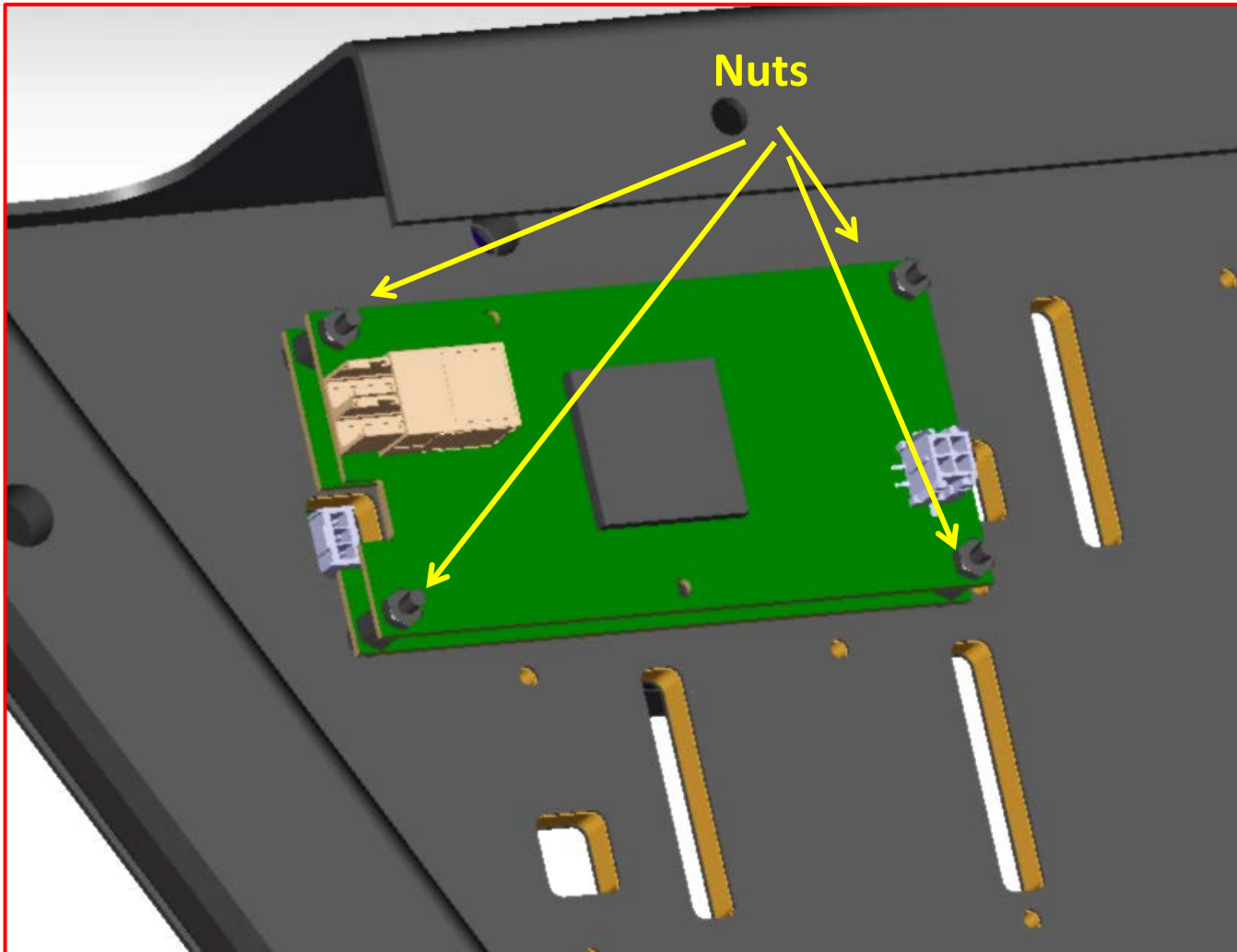

2x tile

Fix the FPGA board with the two nuts

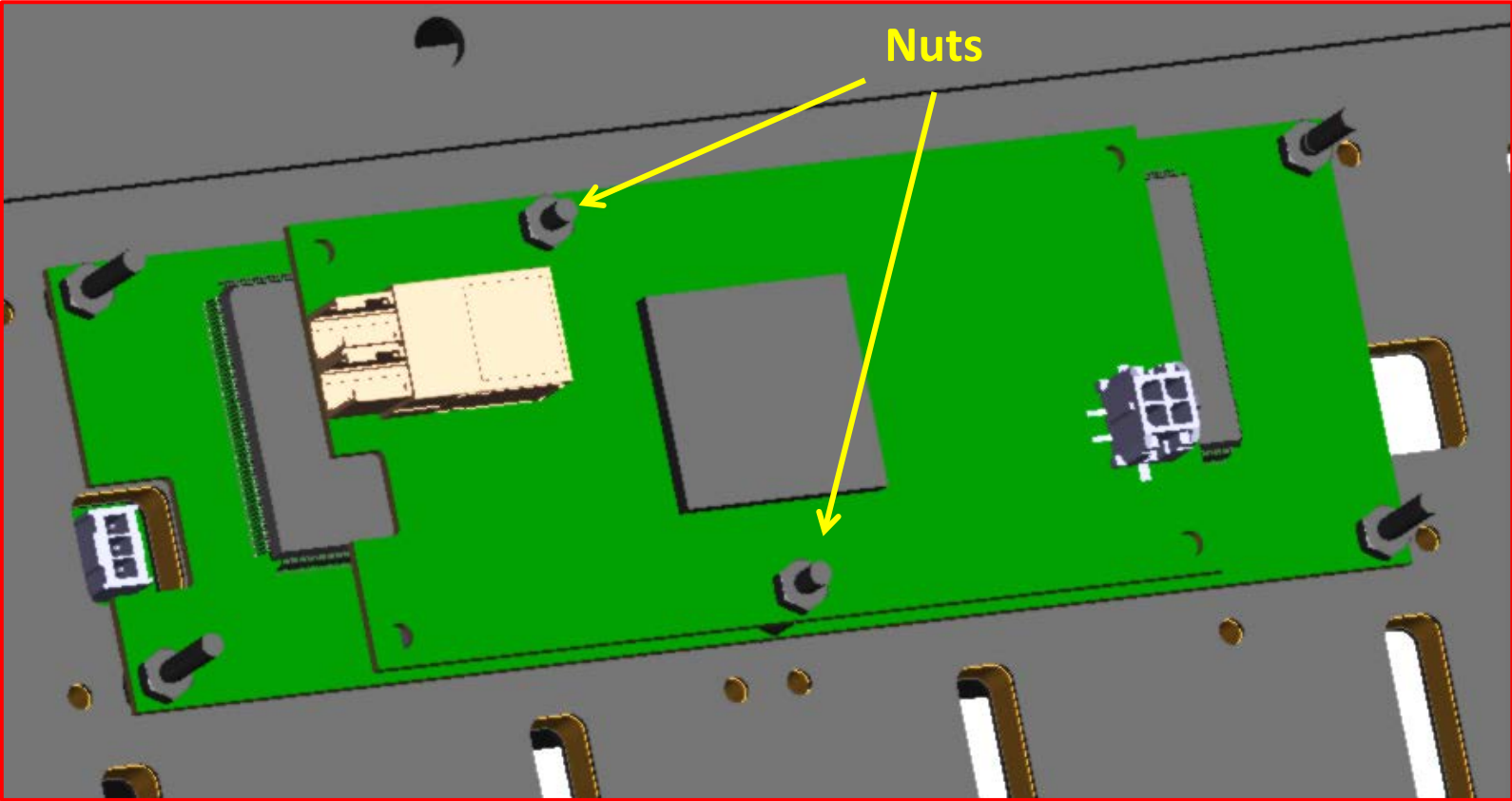

3x tile

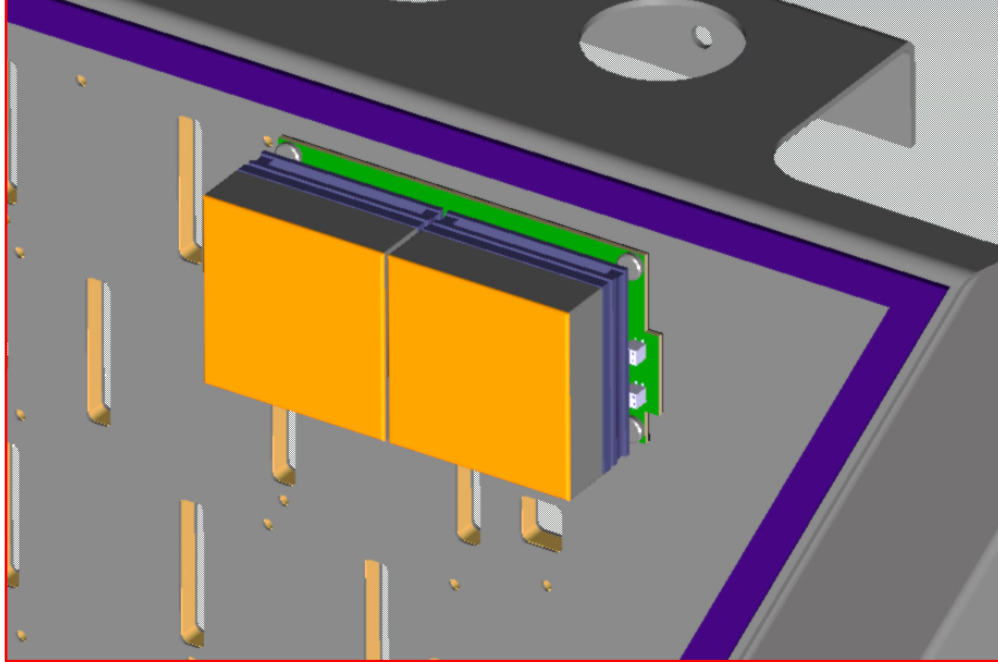

2x tile

Plug the MAPMTs on the adapter board

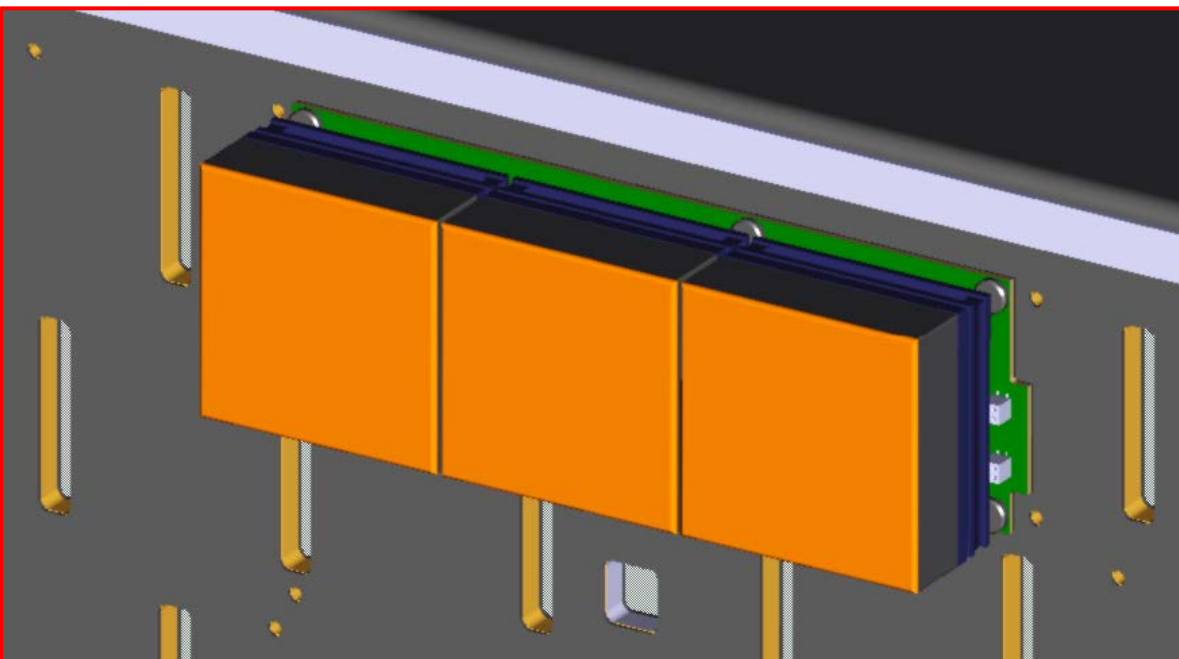

3x tile