

Location TEST LAB	Accelerator Operating Conditions	Instrument: _____ Serial #: _____ Calibration due: _____	RWP
-----------------------------	----------------------------------	--	-----

Reason for survey:

- LEGEND**
All readings in mR/h whole body (unless annotated otherwise)
- Denotes posted area
 - Ⓝ Denotes smear location (results attached if applicable)
 - # Denotes tritium wipe/swab (results attached if applicable)
 - └── Contact dose rate
└── 30 cm dose rate
└── Item description
 - ▨ Denotes area not surveyed

- Abbreviations**
- RMA – radioactive material area
 - RCA – radiologically controlled area
 - RA – radiation area
 - HRA – high radiation area
 - CA – contamination area
 - HCA – high contamination area

- Beam Enclosure Entry Surveys**
- Full survey, all areas posted
 - Partial survey with continuous surveillance
 - N/A

Comments:

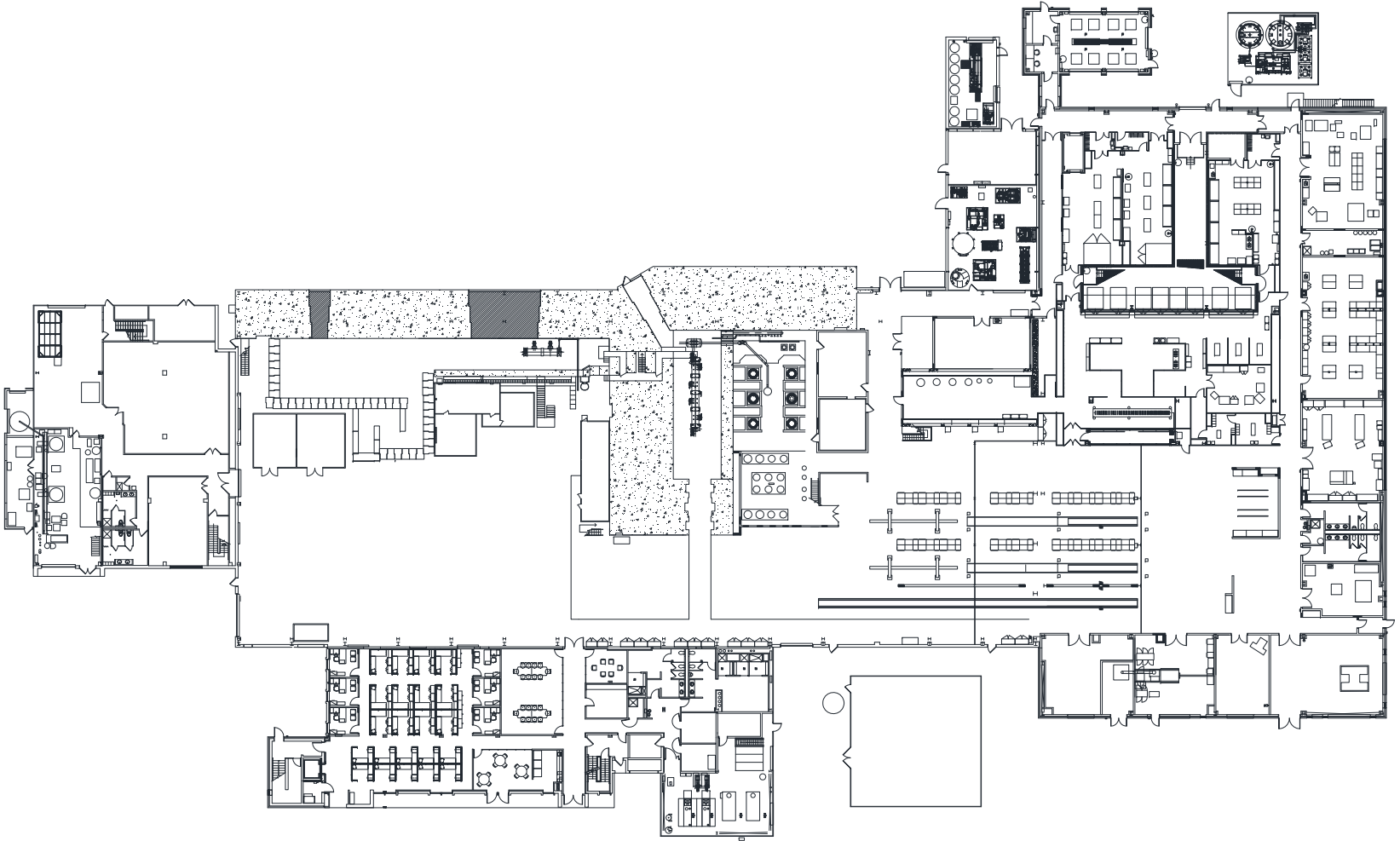

Performed by (print)	Date / /	Crew Chief Review (print)	Date / /	RCD Review (print)	Date
Sign	Time	Sign	Time	Sign	/ /

Location TEST LAB 2nd FLOOR	Accelerator Operating Conditions	Instrument: _____ Serial #: _____ Calibration due: _____	RWP
--	----------------------------------	--	-----

Reason for survey:

- LEGEND**
All readings in mR/h whole body (unless annotated otherwise)
- Denotes posted area
 - Ⓝ Denotes smear location (results attached if applicable)
 - Ⓜ Denotes tritium wipe/swab (results attached if applicable)
 - Contact dose rate
— 30 cm dose rate
— Item description
 - ▨ Denotes area not surveyed

- Abbreviations**
- RMA – radioactive material area
 - RCA – radiologically controlled area
 - RA – radiation area
 - HRA – high radiation area
 - CA – contamination area
 - HCA – high contamination area

Beam Enclosure Entry Surveys

Full survey, all areas posted

Partial survey with continuous surveillance

N/A

Comments:



Performed by (print)	Date / /	Crew Chief Review (print)	Date / /	RCD Review (print)	Date
Sign	Time	Sign	Time	Sign	/ /